

GIVI

EXPLORE. ENJOY.

with... **YAMAHA**



EXPLORE. ENJOY.
givimoto.com

YAMAHA

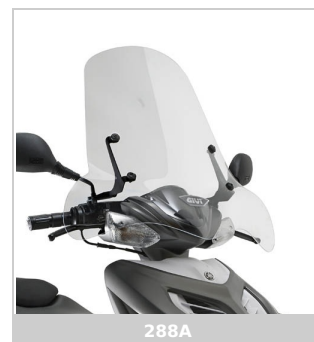
Aerox R 50 (13 > 20)**Accessories**

288A Specific screen, transparent 59 x 70 cm (H x W) *to be combined with the specific A2113A is already fitted*

YAMAHA

Neo's 50 (08 > 21)

Accessories

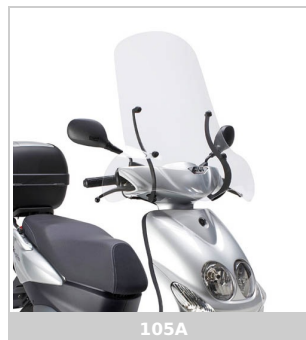

SR366 Specific rear rack for MONOLOCK® top-case *to be combined with the plate already included in the MONOLOCK® top-case*

105A Specific screen, transparent 66 x 67 cm (H x W) *to be combined with the specific A285A fitting kit*

128A Specific screen, transparent 74 x 67 cm (H x W) *only available if article A285A is already fitted / 8 cm higher than 105A*

YAMAHA

Dâ€™ elight 125 (17 > 20)

Accessories

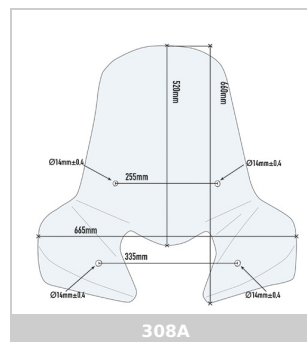

308A



SR2134



A2134A

SR2134 Specific rear rack, black, for MONOLOCK® top-case *to be combined with the plate already included in the MONOLOCK® top-case*

308A Specific screen, transparent with serigraphy 52 x 66,5 cm (H x W) *to be combined with the specific A2134A fitting kit*

A2134A Specific fitting kit for 308A

YAMAHA

Dâ€™™ elight 125 (21 > 22)

Accessories

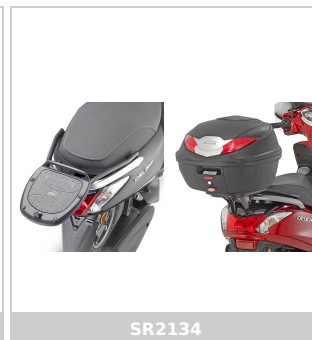
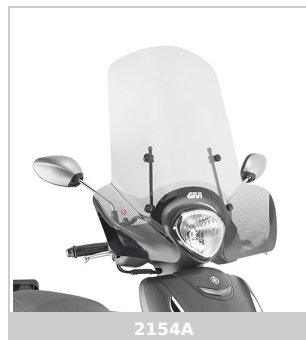

SR2134 Specific rear rack, black, for MONOLOCK® top-case *to be combined with the plate already included in the MONOLOCK® top-case*

2154A Specific screen, transparent 49,5 x 65,5 cm (H x W) *to be combined with the specific A2154A fitting kit*

A2154A Specific fitting kit for 2154A

YAMAHA

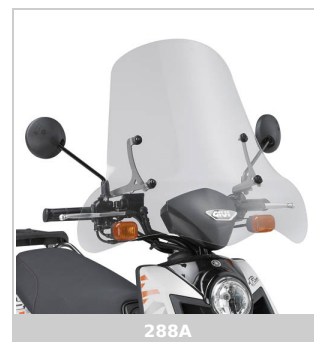
BW'S 125 (10 > 16)**Accessories**

288A Specific screen, transparent 59 x 70 cm (H x W) *only available if article A288A is already fitted*

YAMAHA

Cignus X 125 (04 > 06)**Accessories**

SR354 Specific rear rack for MONOLOCK® top-case *to be combined with the plate already included in the MONOLOCK® top-case*

YAMAHA

Cignus X 125 (07 > 15)**Accessories**

102A



SR354

SR354 Specific rear rack for MONOLOCK® top-case *to be combined with the plate already included in the MONOLOCK® top-case*

102A Specific screen, transparent 66 x 68 cm (H x W) *to be combined with the specific A283A fitting kit*

128A Specific screen, transparent 74 x 67 cm (H x W) *to be combined with the specific A283A fitting kit / 8 cm higher than 102A*

A283A Specific fitting kit for 102A and 128A

YAMAHA

Majesty 125-150-180 (01 > 11)

Accessories

**SR46M**

Specific rear rack for MONOLOCK® top-case *to be combined with the plate already included in the MONOLOCK® top-case*

YAMAHA

Majesty S 125 (14 > 17)**Accessories****2121DT****SR2121****SR2121**

Specific rear rack for MONOLOCK® top-case *to be combined with the plate already included in the MONOLOCK® top-case or with the M5M or M6M MONOLOCK® plate*

2121DT

Specific screen, transparent 70,5 x 50 cm (H x W) *only available if article D2121KIT is already fitted*

YAMAHA

MT 125 (20 > 22)

Accessories

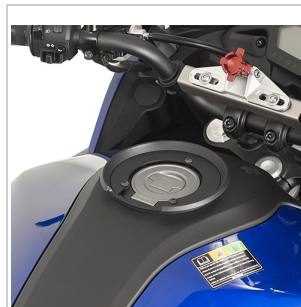

BF05



SR2166



2166A

SR2166 Specific rear rack for MONOLOCK® top-case *to be combined with the plate already included in the MONOLOCK® top-case*

BF05 Specific flange for fitting any of the TANKLOCK, TanklockED bags

2166A Specific screen, smoked 28 x 36,5 cm (H x W) *to be combined with the specific A2166A fitting kit*

A2166A Specific fitting kit for 2166A

YAMAHA

Tricity 125-155 (14 > 22)**Accessories****2120DT****SR2120**

SR2120	Specific rear rack for MONOLOCK® top-case <i>to be combined with the plate already included in the MONOLOCK® top-case or with the plate M6M</i>
2120DT	Specific screen, transparent, 74 x 63 cm (H x W) <i>to be combined with the specific D2120KIT fitting kit</i>
D2120KIT	Specific fitting kit for 2120DT
TB2120A	Specific backrest <i>it cannot be mounted if rack and case are installed</i>

YAMAHA

Vity 125 (10 > 15)

Accessories

**288A**

Specific screen, transparent 59 x 70 cm (H x W) *only available if article A289A is already fitted*

YAMAHA

N-Max 125-155 (15 > 20)**Accessories****2123DT****SR2123**

SR2123 Specific rear rack for MONOLOCK® top-case *to be combined with the plate already included in the MONOLOCK® top-case*

2123DT Specific screen, transparent 81,5 x 64,5 cm (H x W) *to be mounted instead of the original screen / to be combined with the specific D2123KIT fitting kit*

D2123KIT Specific fitting kit for 2123DT

YAMAHA

N-Max 125-155 (21 > 22)

Accessories



2153DT



SR2153

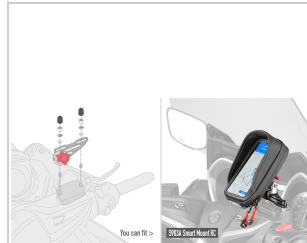

01VKIT

SR2153	Specific rear rack for MONOLOCK® top-case <i>to be combined with the plate already included in the MONOLOCK® top-case</i>
2153DT	Specific screen, transparent 58,5 x 41 cm (H x W) <i>to be combined with the specific D2153KIT fitting kit / 15,5 cm higher than the original</i>
D2153KIT	Specific fitting kit for 2153DT
01VKIT	Specific kit to mount the Smart Mount RC S903A, S904B <i>it can be mounted on the brake fluid reservoir cover either on the right-hand side or left-hand side</i>

YAMAHA

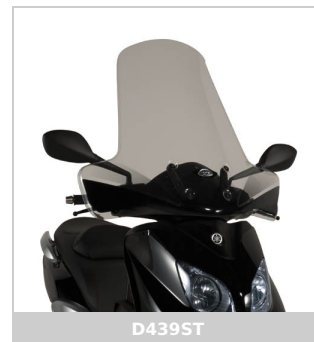
X-CITY 125-250 (07 > 17)**Accessories**

D439ST

D439ST

Specific screen, transparent with serigraphy 71 x 77 cm (H x W) *to be mounted instead of the original screen / 22 cm higher than the original*

YAMAHA

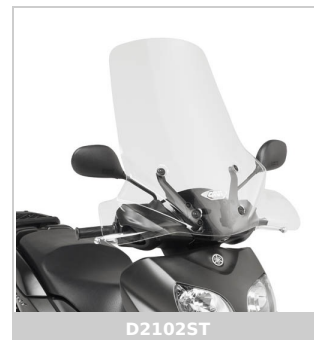
Xenter 125-150 (12 > 21)**Accessories**

D2102ST Specific screen, transparent 65 x 70 cm (H x W) *to be mounted instead of the original screen / 14 cm higher than the original*

YAMAHA

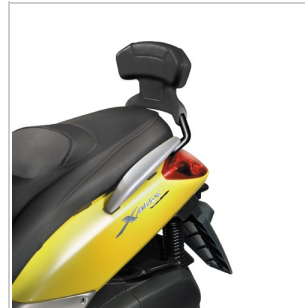
X-MAX 125-250 (05 > 09)**Accessories****D438ST****SR355M****TB49****SR355M**

Specific rear rack for MONOLOCK® top-case *it is necessary to puncture the housing behind the saddle in arranged sections / to be combined with the plate already included in the MONOLOCK® top-case*

D438ST

Specific screen, transparent 63,5 x 69,5 cm (H x W) *to be mounted instead of the original screen / 25,5 cm higher than original*

TB49

Specific backrest *it cannot be mounted if rack and case are installed*

YAMAHA

X-MAX 125-250 (10 > 13)**Accessories**

446DT



SR370



TB55



D446B

SR370

Specific rear rack for MONOKEY® top-case *MONOKEY® plate included / it is necessary to puncture the housing behind the saddle / maximum load allowed 6 kg*

SR370M

Specific rear rack for MONOLOCK® top-case *to be combined with the plate already included in the MONOLOCK® top-case / it is necessary to puncture the housing behind the saddle*

446DT

Specific screen, transparent 73,5 x 63 cm (H x W) *to be combined with the specific D446KIT fitting kit / 30 cm higher than the original*

D446KIT

Specific fitting kit for 446DT

D446B

Specific low sports screen glossy black 37 x 43 cm (H x W) *to be mounted instead of the original screen*

TB55

Specific backrest *it cannot be mounted if rack and case are installed*

YAMAHA

X-MAX 125-250 (14 > 17)**Accessories**

2111DT



SR2117M



TB2111

SR2117M Specific rear rack for MONOLOCK® top-case *to be combined with the plate already included in the MONOLOCK® top-case*

2111DT Specific screen, transparent 73 x 59 cm (H x W) *to be combined with the specific D2111KIT fitting kit*

D2111KIT Specific fitting kit for 2111DT

TB2111 Specific backrest *it cannot be mounted if rack and case are installed*

YAMAHA

X-MAX 125 (18 > 22)**Accessories****SR2150****SR2149****TB2149****D21385****SR2149**

Specific rear rack for MONOLOCK® or MONOKEY® top-case *to be combined with the M5, M7, M8A, M8B, M9A or M9B MONOKEY® plate, or with the M5M or M6M MONOLOCK® plate, or with the aluminium bag holder EX2M / if combined with M8A, M8B, M9A, M9B it does not allow the assembly of the stop light kit or the remote control device on the top-case*

SR2150

Specific rear rack for MONOLOCK® or MONOKEY® top-case *to be combined with the M5 MONOKEY® plate, or with the M5M or M6M MONOLOCK® plate, or with the plate already included in the MONOLOCK® top-case, or with the aluminium bag holder EX2M / it can only be mounted on the original rack, offered as an option by the manufacturer*

D2136ST

Specific screen, transparent 73,5 x 64 cm (H x W) *to be mounted instead of the original screen / 20,5 cm higher than the original*

D2136S

Specific low sports screen smoked 43,5 x 43,5 cm (H x W) *to be mounted instead of the original screen*

D2138S

Specific screen, smoked 64,5 x 57,5 cm (H x W) *to be mounted instead of the original screen / 11,5 cm higher than the original*

TB2149

Specific backrest *it cannot be mounted if rack and case are installed*

YAMAHA

Tricity 300 (20 > 22)

Accessories

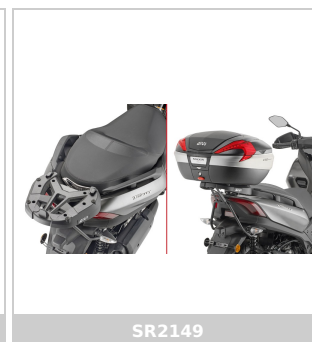
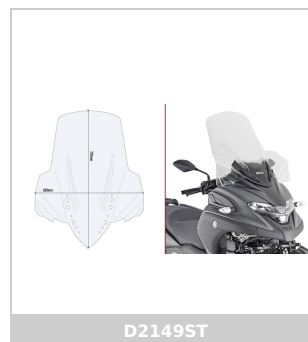

SR2149

Specific rear rack for MONOLOCK® or MONOKEY® top-case *to be combined with the M5, M7, M8A, M8B, M9A or M9B MONOKEY® plate, or with the M5M or M6M MONOLOCK® plate, or with the aluminium bag holder EX2M / if combined with M8A, M8B, M9A, M9B it does not allow the assembly of the stop light kit or the remote control device on the top-case*

D2149ST

Specific screen, transparent, 72 x 60 cm (H x W) *to be mounted instead of the original screen / 19,5 cm higher than the original*

TB2149

Specific backrest *it cannot be mounted if rack and case are installed*

HP2149B

Specific, technopolymer, black hand protectors

YAMAHA

XC 300 Versity (03 > 07)**Accessories**

D432ST Specific screen, transparent 72 x 75 cm (H x W) *to be mounted instead of the original screen / 22 cm higher than the original*

YAMAHA

X-Max 300 (17 > 22)

Accessories



SR2150



SR2149



TB2149



D21385

SR2149

Specific rear rack for MONOLOCK® or MONOKEY® top-case *to be combined with the M5, M7, M8A, M8B, M9A or M9B MONOKEY® plate, or with the M5M or M6M MONOLOCK® plate, or with the aluminium bag holder EX2M / if combined with M8A, M8B, M9A, M9B it does not allow the assembly of the stop light kit or the remote control device on the top-case*

SR2150

Specific rear rack for MONOLOCK® or MONOKEY® top-case *to be combined with the M5 MONOKEY® plate, or with the M5M or M6M MONOLOCK® plate, or with the plate already included in the MONOLOCK® top-case, or with the aluminium bag holder EX2M / it can only be mounted on the original rack, offered as an option by the manufacturer*

D2136ST

Specific screen, transparent 73,5 x 64 cm (H x W) *to be mounted instead of the original screen / 20,5 cm higher than the original*

D2136S

Specific low sports screen smoked 43,5 x 43,5 cm (H x W) *to be mounted instead of the original screen*

D2138S

Specific screen, smoked 64,5 x 57,5 cm (H x W) *to be mounted instead of the original screen / 11,5 cm higher than the original*

TB2149

Specific backrest *it cannot be mounted if rack and case are installed*

YAMAHA

MT-03 321 (16 > 19)

Accessories



A2127



BF05

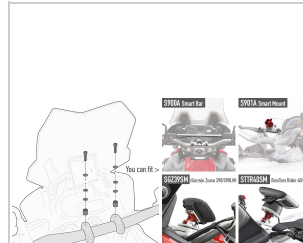

05SKIT

BF05 Specific flange for fitting any of the TANKLOCK, TanklockED bags

A2127 Specific screen, smoked 28 x 38 cm (H x W) *complete with specific fitting kit*

05SKIT Specific kit to mount the S900A Smart Bar or the S901A Smart Mount *The S901A is compatible with the supports SGZ39SM (for Garmin Zumo 345LM/390LM/395LM/590LM/595LM/346LM/396LM) and STTR40SM (for Tom Tom Rider 40/400/410/42/420/450/500/550)*

YAMAHA

MT-03 321 (20 > 22)

Accessories

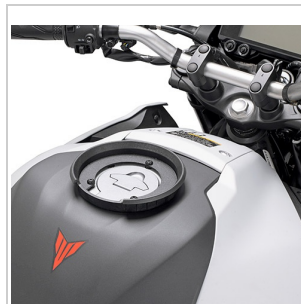

BF54



2151FZ



4128S

2151FZ Specific rear rack for MONOLOCK® top-case *to be combined with the MONOLOCK® M5M or M6M plates*

BF54 Specific flange for fitting any of the TANKLOCK, TanklockED bags

4128S Specific screen, smoked 28 x 36,5 cm (H x W) *to be combined with the specific A2151A fitting kit*

A2151A Specific fitting kit for 4128S

YAMAHA

Majesty 400 (04 > 08)**Accessories****D137ST****E331**

E331 Specific rear rack for MONOKEY® top-case *MONOKEY® plate included*

E331M Specific rear plate for MONOLOCK® top-case *MONOLOCK® plate included*

D137ST Specific screen, transparent 74 x 64 cm (H x W) *to be mounted instead of the original screen / 4 cm higher than the original*

YAMAHA

Majesty 400 (09 > 14)**Accessories****E331****E331** Specific rear rack for MONOKEY® top-case *MONOKEY® plate included***E331M** Specific rear plate for MONOLOCK® top-case *MONOLOCK® plate included*

YAMAHA

X-MAX 400 (13 > 16)**Accessories**

TB2111



2111DT

2111DT Specific screen, transparent 73 x 59 cm (H x W) *to be combined with the specific D2111KIT fitting kit*

D2111KIT Specific fitting kit for 2111DT

TB2111 Specific backrest *it cannot be mounted if rack and case are installed*

YAMAHA

X-MAX 400 (18 > 21)**Accessories****D2138S****SR2150****SR2138**

Specific rear rack for MONOLOCK® or MONOKEY® top-case *to be combined with the M5, M7, M8A, M8B, M9A or M9B MONOKEY® plate, or with the M5M or M6M MONOLOCK® plate, or with the aluminium bag holder EX2M / if combined with M8A, M8B, M9A, M9B it does not allow the assembly of the stop light kit or the remote control device on the top-case / maximum load allowed 6 kg*

SR2150

Specific rear rack for MONOLOCK® or MONOKEY® top-case *to be combined with the M5 MONOKEY® plate, or with the M5M or M6M MONOLOCK® plate, or with the plate already included in the MONOLOCK® top-case, or with the aluminium bag holder EX2M / it can only be mounted on the original rack, offered as an option by the manufacturer*

D2136ST

Specific screen, transparent 73,5 x 64 cm (H x W) *to be mounted instead of the original screen / 20,5 cm higher than the original*

D2136S

Specific low sports screen smoked 43,5 x 43,5 cm (H x W) *to be mounted instead of the original screen*

D2138S

Specific screen, smoked 64,5 x 57,5 cm (H x W) *to be mounted instead of the original screen / 11,5 cm higher than the original*

YAMAHA

T-MAX 500 (01 > 07)**Accessories****D128ST****SR45****TB51****D128B**

SR45 Specific rear rack for MONOKEY® top-case *MONOKEY® plate included / it is necessary to puncture the housing behind the saddle*

D128ST Specific screen, transparent 80,1 x 64,5 cm (H x W) *to be mounted instead of the original screen*

D128B Specific low sports screen glossy black 52 x 44,5 cm (H x W) *to be mounted instead of the original screen*

TB51 Specific backrest *it cannot be mounted if rack and case are installed*

YAMAHA

T-MAX 500 (08 > 11)

Accessories

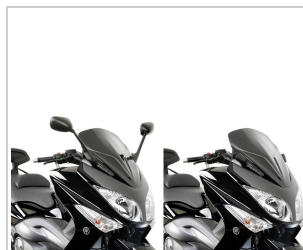

D442B



SR2013



D442ST

SR2013	Specific rear rack for MONOKEY® top-case <i>MONOKEY® plate included / maximum load allowed 6 Kg / it is necessary to puncture the housing behind the saddle</i>
SR2013M	Specific rear rack for MONOLOCK® top-case <i>MONOLOCK® plate included / it is necessary to puncture the housing behind the saddle</i>
D442B	Specific low sports screen glossy black 59 x 45 cm (H x W) <i>including two rubber blanking stoppers for those who wish to move the screen from its original position</i>
D442ST	Specific screen, transparent 50 x 57 cm (H x W) <i>to be mounted instead of the original screen / 16 cm higher than the original</i>
TB2013A	Specific backrest <i>it cannot be mounted if rack and case are installed</i>

YAMAHA

T-MAX 530 (12 > 16)**Accessories****D2013ST****SR2013****D2013B**

SR2013	Specific rear rack for MONOKEY® top-case <i>MONOKEY® plate included / maximum load allowed 6 Kg / it is necessary to puncture the housing behind the saddle</i>
SR2013M	Specific rear rack for MONOLOCK® top-case <i>MONOLOCK® plate included / it is necessary to puncture the housing behind the saddle</i>
D2013ST	Specific screen, transparent 65 x 61 cm (H x W) <i>to be mounted instead of the original screen</i>
D2013B	Specific low sports screen glossy black 46 x 48 cm (H x W) <i>to be mounted instead of the original screen</i>
TB2013A	Specific backrest <i>it cannot be mounted if rack and case are installed</i>

YAMAHA

T-MAX 530 (17 > 19)

Accessories

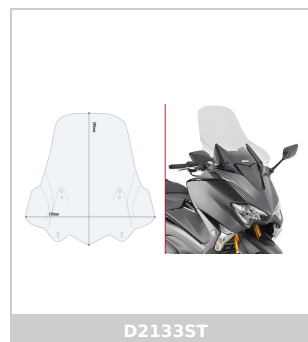

D2133ST



SR2133

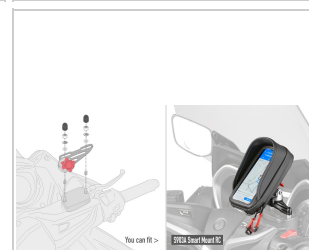

01VKIT

SR2133

Specific rear rack for MONOLOCK® or MONOKEY® top-case *to be combined with the M5, M7, M8A, M8B, M9A or M9B MONOKEY® plate, or with the M5M or M6M MONOLOCK® plate, or with the aluminium bag holder EX2M / if combined with M9A, M9B it does not allow the assembly of the stop light kit or the remote control device on the top-case / maximum load allowed 6 kg*

D2133ST

Specific screen, transparent 59,5 x 61 cm (H x W) *to be mounted instead of the original screen / 12,5 cm higher than the original*

01VKIT

Specific kit to mount the Smart Mount RC S903A, S904B *it can be mounted on the brake fluid reservoir cover either on the right-hand side or left-hand side*

YAMAHA

T-MAX 560 (20 > 21)

Accessories

**SR2147**

Specific rear rack for MONOLOCK® or MONOKEY® top-case *to be combined with the M5, M8A, M8B, M9A or M9B MONOKEY® plate, or with the M5M or M6M MONOLOCK® plate, or with the aluminium bag holder EX2M / if combined with M8A, M8B, M9A, M9B it does not allow the assembly of the stop light kit or the remote control device on the top-case*

D2133ST

Specific screen, transparent 59,5 x 61 cm (H x W) *to be mounted instead of the original screen / 12,5 cm higher than the original*

D2147B

Specific low sports screen smoked 32 x 52 cm (H x W) *to be mounted instead of the original screen*

01VKIT

Specific kit to mount the Smart Mount RC S903A, S904B *it can be mounted on the brake fluid reservoir cover either on the right-hand side or left-hand side*

YAMAHA

T-MAX 560 (22)

Accessories

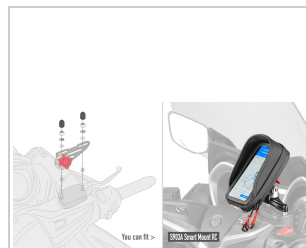

02VKIT



SR2161



D2161ST

SR2161

Specific rear rack for MONOLOCK® or MONOKEY® top-case *to be combined with the M5, M8A, M8B, M9A or M9B MONOKEY® plate, or with the M5M or M6M MONOLOCK® plate, or with the aluminium bag holder EX2M / if combined with M8A, M8B, M9A, M9B it does not allow the assembly of the stop light kit or the remote control device on the top-case*

02VKIT

Specific kit to mount the Smart Mount RC S903A, S904B

D2161ST

Specific screen, transparent 62,5 x 59,5 cm (H x W) *to be mounted instead of the original screen*

YAMAHA

FZ6/FZ6 600 Fazer (04 > 06)

Accessories



PLX351

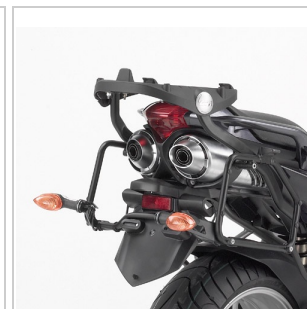

351FZ



BF05



T351

351FZ

Specific rear rack for MONOKEY® or MONOLOCK® top-case *to be combined with the MONOKEY® M5, M7, M8A, M8B, M9A or M9B plates, or with the MONOLOCK® M5M or M6M plates, or with the aluminium bag holder EX2M / if combined with M8A, M8B, M9A, M9B it does not allow the assembly of the stop light kit or the remote control device on the top-case*

PLX351

Specific pannier holder for V35 MONOKEY® SIDE cases *it can be mounted only with the specific rear rack 351FZ / it is necessary to move the indicators from their original position / only compatible with V35 MONOKEY® SIDE*

T351

Specific holder for soft side bags *it can be mounted without the specific rear rack 351FZ using the 351KIT*

BF05

Specific flange for fitting any of the TANKLOCK, Tanklocked bags

D136ST

Specific screen, transparent 61 x 53,5 cm (H x W) *for FZ6 Fazer version / to be mounted instead of the original screen / 12,5 cm higher than the original*

140D

Specific screen, smoked 35 x 36cm (H x W) *only for FZ6 / to be combined with the specific D140KIT fitting kit*

D140KIT

Specific fitting kit for 140D *only for FZ6 /*

TN358

Specific engine guard 25 mm diameter steel tube / *we recommend fitting by a qualified mechanic / mount with original central stand mounted*



D136ST



140D



TN358

YAMAHA

FZ6 S2 / FZ6 600 Fazer S2 (07 > 11)

Accessories



BF05

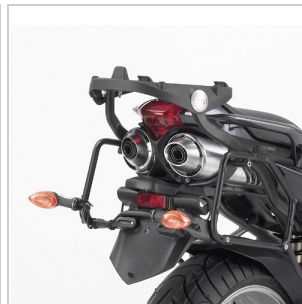

351FZ

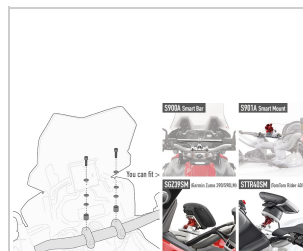

01SKIT



TN358

351FZ

Specific rear rack for MONOKEY® or MONOLOCK® top-case *to be combined with the MONOKEY® M5, M7, M8A, M8B, M9A or M9B plates, or with the MONOLOCK® M5M or M6M plates, or with the aluminium bag holder EX2M / if combined with M8A, M8B, M9A, M9B it does not allow the assembly of the stop light kit or the remote control device on the top-case*

BF05

Specific flange for fitting any of the TANKLOCK, TanklockED bags

TN358

Specific engine guard 25 mm diameter steel tube / *we recommend fitting by a qualified mechanic / mount with original central stand mounted*

01SKIT

Specific kit to mount the S900A Smart Bar or the S901A Smart Mount *The S901A is compatible with the supports SGZ39SM (for Garmin Zumo 345LM/390LM/395LM/590LM/595LM/346LM/396LM) and STTR40SM (for Tom Tom Rider 40/400/410/42/420/450/500/550)*

YAMAHA

XJ6 (09>12) / XJ6 Diversion / XJ6 Diversion F 600 (09 > 13)

Accessories

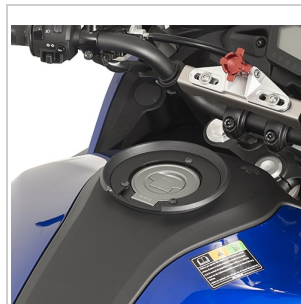

BF05



364FZ

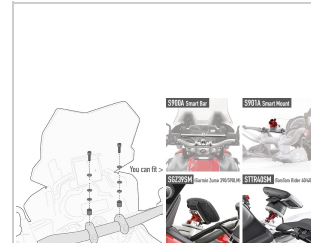

05SKIT

364FZ

Specific rear rack for MONOKEY® or MONOLOCK® top-case *to be combined with the MONOKEY® M5, M7, M8A, M8B, M9A or M9B plates, or with the MONOLOCK® M5M or M6M plates, or with the aluminium bag holder EX2M / if combined with M8A, M8B, M9A, M9B it does not allow the assembly of the stop light kit or the remote control device on the top-case*

BF05

Specific flange for fitting any of the TANKLOCK, TanklockED bags

05SKIT

Specific kit to mount the S900A Smart Bar or the S901A Smart Mount *The S901A is compatible with the supports SGZ395M (for Garmin Zumo 345LM/390LM/395LM/590LM/595LM/346LM/396LM) and STTR40SM (for Tom Tom Rider 40/400/410/42/420/450/500/550)*

YAMAHA

XJ6 600 (13 > 15)

Accessories

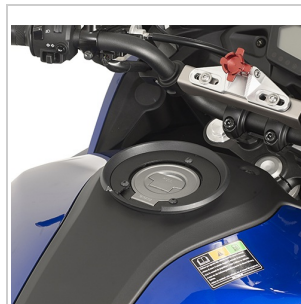

BF05



364FZ

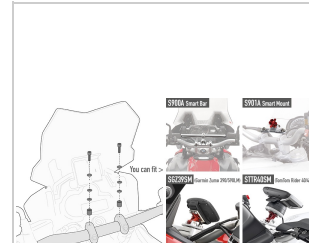

05SKIT

364FZ

Specific rear rack for MONOKEY® or MONOLOCK® top-case *to be combined with the MONOKEY® M5, M7, M8A, M8B, M9A or M9B plates, or with the MONOLOCK® M5M or M6M plates, or with the aluminium bag holder EX2M / if combined with M8A, M8B, M9A, M9B it does not allow the assembly of the stop light kit or the remote control device on the top-case*

BF05

Specific flange for fitting any of the TANKLOCK, TanklockED bags

05SKIT

Specific kit to mount the S900A Smart Bar or the S901A Smart Mount *The S901A is compatible with the supports SGZ395M (for Garmin Zumo 345LM/390LM/395LM/590LM/595LM/346LM/396LM) and STTR405M (for Tom Tom Rider 40/400/410/42/420/450/500/550)*

YAMAHA

MT-03 660 (06 > 14)

Accessories

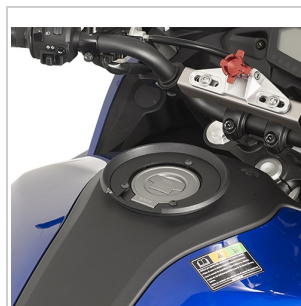

BF05



356FZ



245N



T129

356FZ

Specific rear rack for MONOKEY® or MONOLOCK® top-case *to be combined with the MONOKEY® M5, M7, M8A, M8B, M9A or M9B plates, or with the MONOLOCK® M5M or M6M plates, or with the aluminium bag holder EX2M / if combined with M8A, M8B, M9A, M9B it does not allow the assembly of the stop light kit or the remote control device on the top-case / maximum load allowed 6 Kg / with integrated passenger grabrails*

BF05

Specific flange for fitting any of the TANKLOCK, TanklockED bags

T129

Specific holder for soft side bags

245A

Universal screen, smoked 33,5 x 29 cm (H x W) *to be combined with the specific A281A fitting kit*

245N

Universal screen black 33,5 x 29 cm (H x W)

A281A

Specific fitting kit for 245A, 245N, 246_ _ _



A281A

YAMAHA

YZF 600 R6 (06 > 07)

Accessories

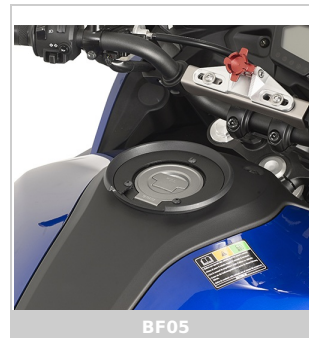

BF05 Specific flange for fitting any of the TANKLOCK, TanklockED bags

YAMAHA

XT 660 R / XT 660 X (04 > 06)**Accessories**

D433S Specific screen, smoked 37 x 36,5 cm (H x W) *only for XT 660 R version / to be mounted instead of the original screen*

YAMAHA

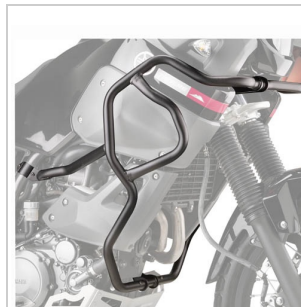
XT 660Z TÄ©nÄ©rÄ© (08 > 16)**Accessories****TN2105****D443ST**

D443ST Specific screen, transparent 40 x 42 cm (H x W) *to be mounted instead of the original screen / 10 cm higher than the original*

TN2105 Specific engine guard 25 mm diameter steel tube / *we recommend fitting by a qualified mechanic*

YAMAHA

MT-07 (14 > 17)

Accessories



BF21



2118FZ



A2118

2118FZ

Specific rear rack for MONOKEY® or MONOLOCK® top-case *to be combined with the MONOKEY® M5, M7, M8A, M8B, M9A or M9B plates, or with the MONOLOCK® M5M or M6M plates, or with the aluminium bag holder EX2M / if combined with M8A, M8B, M9A, M9B it does not allow the assembly of the stop light kit or the remote control device on the top-case / it is necessary to puncture the housing under the tail*

BF21

Specific flange for fitting any of the TANKLOCK, TanklockED bags

A2118

Specific screen, black 28,5 x 36 cm (H x W) *complete with specific fitting kit*

HP2115B

Specific, technopolymer, black hand protectors

YAMAHA

MT-07 (18 > 20)

Accessories



BF36



TE2140



PR2126



TN2130

2140FZ

Specific rear rack for MONOKEY® or MONOLOCK® top-case *to be combined with the MONOKEY® M5, M7, M8A, M8B, M9A or M9B plates, or with the MONOLOCK® M5M or M6M plates, or with the aluminium bag holder EX2M / if combined with M8A, M8B, M9A, M9B it does not allow the assembly of the stop light kit or the remote control device on the top-case / maximum load allowed 6 Kg*

TE2140

Specific holder for Easylock side bags, or soft side bags *it can be mounted without the specific rear rack 2140FZ using the 2140KIT*

2140KIT

Specific kit to install the TE2140 without the specific rear rack 2140FZ

TR2157

Specific rapid release holder REMOVE-X for soft side bags

BF36

Specific flange for fitting any of the TANKLOCK, TanklockedED bags *only compatible with bags of up to 5 ltr in capacity*

A2140

Specific screen, smoked 28 x 36,5 cm (H x W) *complete with specific fitting kit*

TN2130

Specific engine guard, black 25 mm diameter steel tube / *we recommend fitting by a qualified mechanic*

PR2126

Stainless steel specific radiator guard black painted

SLD2140KIT

Specific kit to install the frame slider SLD01_ *to be combined with slider SLD01_*

HP2115B

Specific, technopolymer, black hand protectors

02VKIT

Specific kit to mount the Smart Mount RC S903A, S904B *needs to be mounted on the brake fluid reservoir cover right-hand side*

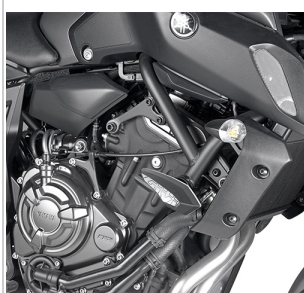

SLD2140KIT

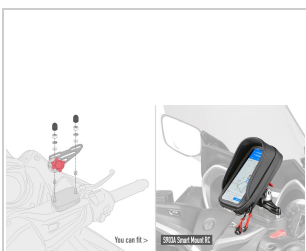

02VKIT

YAMAHA

MT-07 (21 > 22)

Accessories

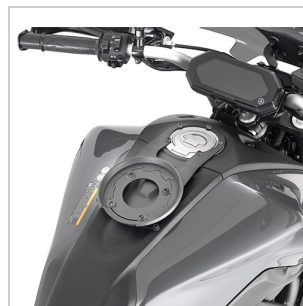

BF60

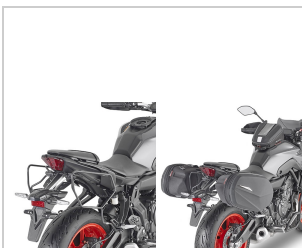

TE2140



PR2126



1173S

2140FZ

Specific rear rack for MONOKEY® or MONOLOCK® top-case *to be combined with the MONOKEY® M5, M7, M8A, M8B, M9A or M9B plates, or with the MONOLOCK® M5M or M6M plates, or with the aluminium bag holder EX2M / if combined with M8A, M8B, M9A, M9B it does not allow the assembly of the stop light kit or the remote control device on the top-case / maximum load allowed 6 Kg*

TE2140

Specific holder for Easylock side bags, or soft side bags *it can be mounted without the specific rear rack 2140FZ using the 2140KIT*

2140KIT

Specific kit to install the TE2140 without the specific rear rack 2140FZ

TR2157

Specific rapid release holder REMOVE-X for soft side bags

BF60

Specific flange for fitting any of the TANKLOCK, TanklockED bags

1173S

Specific screen, smoked 22 x 31 cm (H x W) *to be combined with the specific A2157A fitting kit*

A2157A

Specific fitting kit for 1173S

PR2126

Stainless steel specific radiator guard black painted

SLD2140KIT

Specific kit to install the frame slider SLD01_ _ *to be combined with slider SLD01_ _*

HP2115B

Specific, technopolymer, black hand protectors

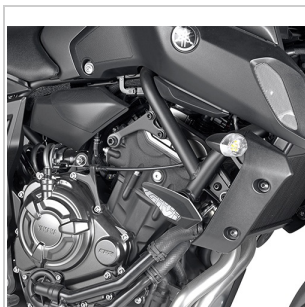

SLD2140KIT

YAMAHA

MT-07 Tracer (16 > 19)

Accessories



D2130S



BF05



TN2130



D2130ST

2130FZ

Specific rear rack for MONOKEY® or MONOLOCK® top-case *to be combined with the kit 2130KIT when the original rigid side-cases are mounted / to be combined with the MONOKEY® M5, M7, M8A, M8B, M9A or M9B plates, or with the MONOLOCK® M5M or M6M plates, or with the aluminium bag holder EX2M / if combined with M8A, M8B, M9A, M9B it does not allow the assembly of the stop light kit or the remote control device on the top-case*

2130KIT

Specific kit to install the specific rear rack 2130FZ with the original hard side-cases *to be combined with 2130FZ*

PLXR2130

Specific rapid release side-case holder for V35, V37 MONOKEY® SIDE cases

BF05

Specific flange for fitting any of the TANKLOCK, Tanklocked bags

D2130S

Specific screen, smoked 51 x 41 cm (H x W) *to be mounted instead of the original screen / 12 cm higher than the original*

D2130ST

Specific screen, transparent 56 x 41 cm (H x W) *to be mounted instead of the original screen / 17 cm higher than the original*

TN2130

Specific engine guard, black 25 mm diameter steel tube / *we recommend fitting by a qualified mechanic*

TNH2130

Specific engine guard, black / *it must be mounted with TN213025 mm diameter steel tube / we recommend fitting by a qualified mechanic / it protects the upper part of the radiators*

PR2130

Stainless steel specific radiator guard black painted

EH2130

Extension in ABS for original hand protectors

ES2130

Specific support in aluminium and stainless steel to widen the surface support area of the original side stand

FB2130

Fairing upper bracket to be mounted behind the windshield to install S902A, S920M, S920L, S95KIT and GPS-Smartphone holder *Compatible with the original windshield and the windshield D2130ST, D2130S, D2130BO / For S902A, S920M, S920L, S95KIT, S952B, S953B, S954B, S955B, S956B, S957B, S958B*

06SKIT

Specific kit to mount the S900A Smart Bar or the S901A Smart Mount *The S901A is compatible with the supports SGZ395M (for Garmin Zumo 345LM/390LM/395LM/590LM/595LM/346LM/396LM) and STTR405M (for Tom Tom Rider 40/400/410/42/420/450/500/550)*

02VKIT

Specific kit to mount the Smart Mount RC S903A, S904B *needs to be mounted on the brake fluid reservoir cover right-hand side / also compatible with version Tracer 700 GT (19)*



TNH2130



PR2130



EH2130

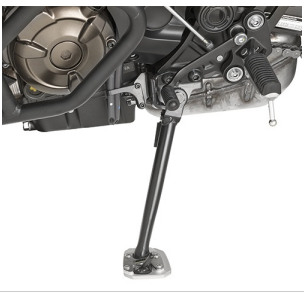

ES2130

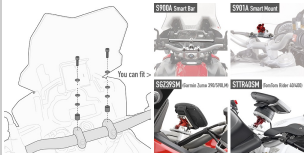

06SKIT

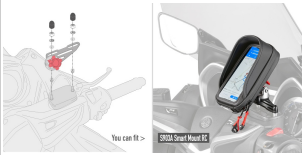

02VKIT

YAMAHA

TÄ©nÄ©rÄ© 700 (19 > 20)

Accessories



PLO2145MK



SR2145

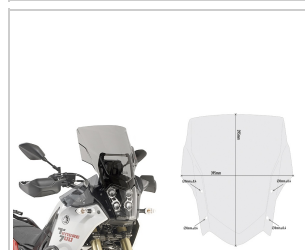

D2145S

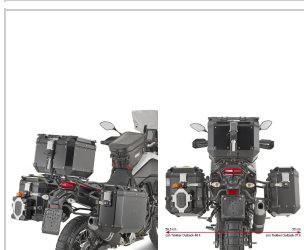

PLO2145CAM

SR2145

Specific rear rack for MONOLOCK® or MONOKEY® top-case *to be combined with the M5, M8A, M8B, M9A or M9B MONOKEY® plate, or with the M5M or M6M MONOLOCK® plate, or with the aluminium bag holder EX2M / if combined with M8A, M8B, M9A, M9B it does not allow the assembly of the stop light kit or the remote control device on the top-case*

PLO2145MK

Specific pannier holder PL ONE-FIT for MONOKEY® side-cases configuration *18 mm diameter*

PLO2145CAM

Specific pannier holder PL ONE-FIT for Trekker Outback MONOKEY® CAM-SIDE configuration *18 mm diameter*

D2145S

Specific screen, smoked 39,5 x 39,5 cm (H x W) *to be mounted instead of the original screen*

D2145ST

Specific screen, transparent 52 x 42 cm (H x W) *to be mounted instead of the original screen*

DF2145

Pair of protective smoked handle-bar wind deflectors *to be mounted instead of the original deflectors*

TN2145

Specific engine guard, black 25 mm diameter steel tube / *we recommend fitting by a qualified mechanic*

RP2145

Oil carter protector in brushed and anodised aluminium *thickness of 5 mm*

ES2145

Specific support in aluminium and stainless steel to widen the surface support area of the original side stand

05SKIT

Specific kit to mount the S900A Smart Bar or the S901A Smart Mount *The S901A is compatible with the supports SGZ39SM (for Garmin Zumo 345LM/390LM/395LM/590LM/595LM/346LM/396LM) and STTR40SM (for Tom Tom Rider 40/400/410/42/420/450/500/550)*

01VKIT

Specific kit to mount the Smart Mount RC S903A, S904B *needs to be mounted on the brake fluid reservoir cover right-hand side*

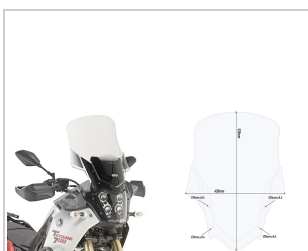

D2145ST



DF2145

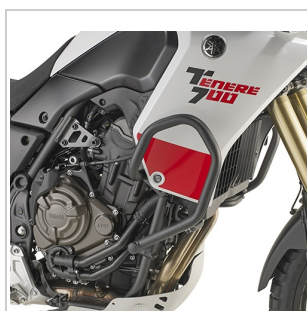

TN2145

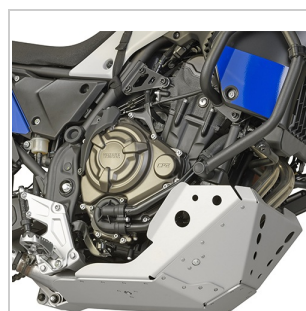

RP2145



ES2145

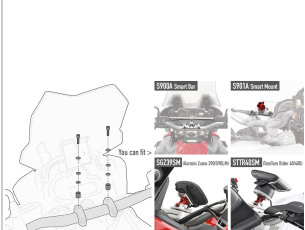

05SKIT

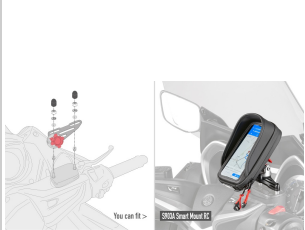

01VKIT

YAMAHA

TÄ©nÄ©rÄ© 700 (21 > 22)

Accessories



PLO2145MK



SR2145

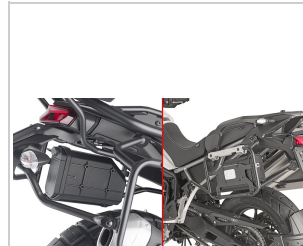

TL6415KIT

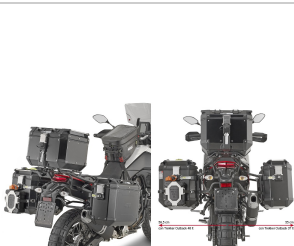

PLO2145CAM

SR2145

Specific rear rack for MONOLOCK® or MONOKEY® top-case *to be combined with the M5, M8A, M8B, M9A or M9B MONOKEY® plate, or with the M5M or M6M MONOLOCK® plate, or with the aluminium bag holder EX2M / if combined with M8A, M8B, M9A, M9B it does not allow the assembly of the stop light kit or the remote control device on the top-case*

PLO2145MK

Specific pannier holder PL ONE-FIT for MONOKEY® side-cases configuration *18 mm diameter*

PLO2145CAM

Specific pannier holder PL ONE-FIT for Trekker Outback MONOKEY® CAM-SIDE configuration *18 mm diameter*

TL6415KIT

Specific kit to install the S250 Tool Box on PLO2145MK, PLO2145CAM *to be combined with S250 and PLO2145MK, PLO2145CAM / needs to be mounted on the left-hand side of the motorcycle*

BF61

Specific flange for fitting any of the TANKLOCK, TanklockED bags

D2145S

Specific screen, smoked 39,5 x 39,5 cm (H x W) *to be mounted instead of the original screen*

D2145ST

Specific screen, transparent 52 x 42 cm (H x W) *to be mounted instead of the original screen*

DF2145

Pair of protective smoked handle-bar wind deflectors *to be mounted instead of the original deflectors*

TN2158

Specific engine guard, black *25 mm diameter steel tube / we recommend fitting by a qualified mechanic*

LS2158

Specific fitting kit to mount spotlights where specific engine guard is not present

ES2145

Specific support in aluminium and stainless steel to widen the surface support area of the original side stand

05SKIT

Specific kit to mount the S900A Smart Bar or the S901A Smart Mount *The S901A is compatible with the supports SGZ395M (for Garmin Zumo 345LM/390LM/395LM/590LM/595LM/346LM/396LM) and STTR405M (for Tom Tom Rider 40/400/410/42/420/450/500/550)*

01VKIT

Specific kit to mount the Smart Mount RC S903A, S904B *needs to be mounted on the brake fluid reservoir cover right-hand side*



BF61

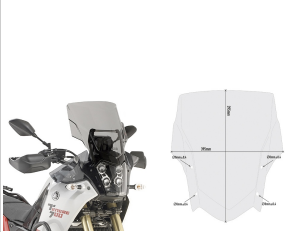

D21455



D21455T



DF2145



TN2158



LS2158



ES2145

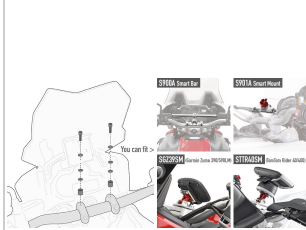

05SKIT

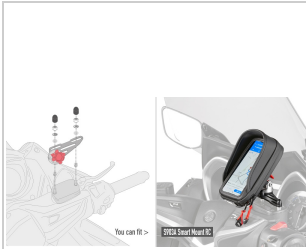

01VKIT

YAMAHA

TÄ©nÄ©rÄ© 700 World Raid (22)

Accessories



PLO2145MK



SR2145



BF75

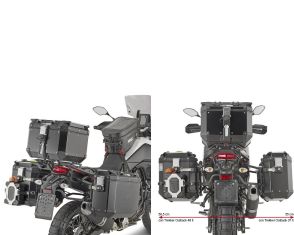

PLO2145CAM

SR2145

Specific rear rack for MONOLOCK® or MONOKEY® top-case *to be combined with the M5, M8A, M8B, M9A or M9B MONOKEY® plate, or with the M5M or M6M MONOLOCK® plate, or with the aluminium bag holder EX2M / if combined with M8A, M8B, M9A, M9B it does not allow the assembly of the stop light kit or the remote control device on the top-case*

PLO2145MK

Specific pannier holder PL ONE-FIT for MONOKEY® side-cases configuration *18 mm diameter*

PLO2145CAM

Specific pannier holder PL ONE-FIT for Trekker Outback MONOKEY® CAM-SIDE configuration *18 mm diameter*

TL6415KIT

Specific kit to install the S250 Tool Box on PLO6415MK, PLO6415CAM and PLO6415N *to be combined with S250 and PLO6415MK, PLO6415CAM and PLO6415N / needs to be mounted on the left-hand side of the motorcycle*

BF75

Specific flange for fitting any of the TANKLOCK, TanklockED bags *only compatible with EA143, EA144, XS308, MT505, ST605B, ST611, ST612*

D2165ST

Specific screen, transparent 52 x 43 cm (H x W)

D2165S

Specific screen, smoked 40 x 43 cm (H x W) *to be mounted instead of the original screen / 10,5 cm higher than the original*

TN2165

Specific engine guard, black 25 mm diameter steel tube / *we recommend fitting by a qualified mechanic*

LS2158

Specific fitting kit to mount spotlights where specific engine guard is not present

ES2145

Specific support in aluminium and stainless steel to widen the surface support area of the original side stand



D2165ST

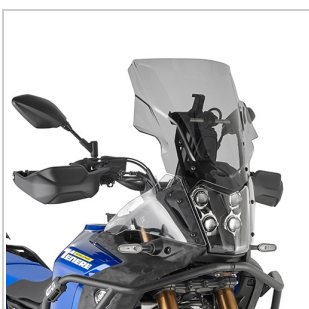

D2165S



TN2165



LS2158



ES2145

YAMAHA

Tracer 700 (20 > 22)

Accessories

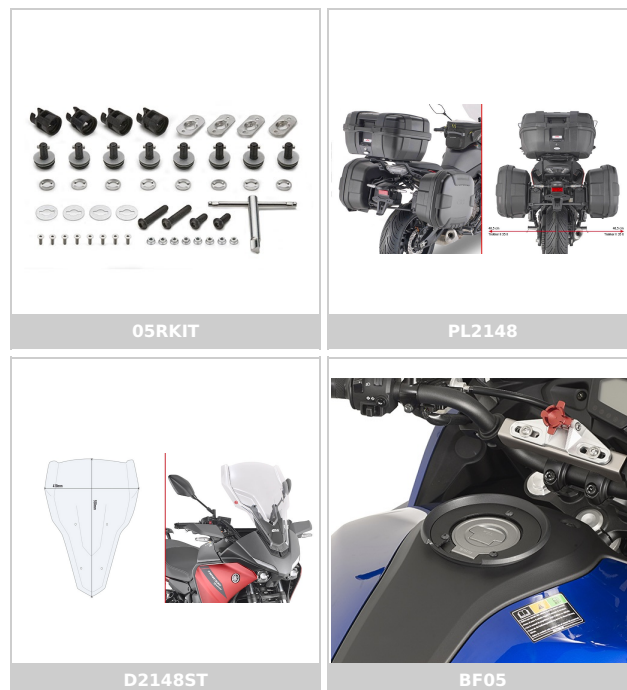

2130FZ

Specific rear rack for MONOKEY® or MONOLOCK® top-case *to be combined with the kit 2130KIT when the original rigid side-cases are mounted / to be combined with the MONOKEY® M5, M7, M8A, M8B, M9A or M9B plates, or with the MONOLOCK® M5M or M6M plates, or with the aluminium bag holder EX2M / if combined with M8A, M8B, M9A, M9B it does not allow the assembly of the stop light kit or the remote control device on the top-case*

2130KIT

Specific kit to install the specific rear rack 2130FZ with the original hard side-cases *to be combined with 2130FZ*

PL2148

Specific pannier holder for MONOKEY® or RETRO FIT side-cases *to be combined with 05RKIT for the transformation into Rapid Release pannier holder*

PL2148KIT

Specific kit to install the PL2148 on the original rack, offered as an option by the manufacturer

05RKIT

RAPID RELEASE kit that allows you to transform the side case holder into a quick-release frame *to be combined with PL2148*

PLXR2130

Specific rapid release side-case holder for V35, V37 MONOKEY® SIDE cases

TR2148

Specific rapid release holder REMOVE-X for soft side bags

BF05

Specific flange for fitting any of the TANKLOCK, Tanklocked bags

D2148ST

Specific screen, transparent 55 x 41 cm (H x W) *to be mounted instead of the original screen / 17,5 cm higher than the original*

TN2148B

Specific engine guard, black 25 mm diameter steel tube / *we recommend fitting by a qualified mechanic*

TNH2130

Specific engine guard, black / *it must be mounted with TN2148 25 mm diameter steel tube / we recommend fitting by a qualified mechanic / it protects the upper part of the radiators*

PR2130

Stainless steel specific radiator guard black painted

ES2130

Specific support in aluminium and stainless steel to widen the surface support area of the original side stand



TNH2130



PR2130

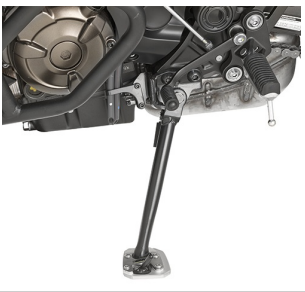

ES2130

YAMAHA

XSR700 (16 > 21)

Accessories



TMT2126

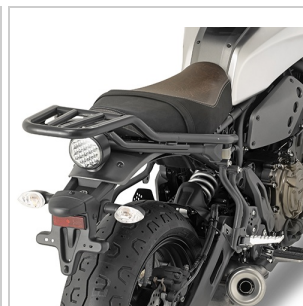

SR2126



PR2126



BF24

SR2126	Specific rear rack, black, for MONOLOCK® or MONOKEY® top-case <i>to be combined with the E251 MONOKEY® plate (sold separately), or with the plate already included in the MONOLOCK® top-cases</i>
TMT2126	Specific holder for pair of side bags MT501 (Metro-T range)
BF24	Specific flange for fitting any of the TANKLOCK, Tanklocked bags <i>not compatible with bags that have a curved base (XS308, EA118, EA143, ST603B, ST612B, UT810)</i>
100AL	Grey anodised aluminium universal screen Race Cafe, for naked motorcycles 20,5 x 26,5 cm (H x W) <i>only available if article AL2126A is already fitted</i>
100ALB	Black anodised aluminium universal screen Race Cafe, for naked motorcycles 20,5 x 26,5 cm (H x W) <i>only available if article AL2126A is already fitted</i>
140A	Universal transparent screen 35 x 41cm (H x W) <i>only available if article AL2126A is already fitted</i>
140S	Universal smoked screen 35 x 41 cm (H x W) <i>only available if article AL2126A is already fitted</i>
PR2126	Stainless steel specific radiator guard black painted
HP2115B	Specific, technopolymer, black hand protectors

YAMAHA

FZ8 / Fazer 8 800 (10 > 15)

Accessories

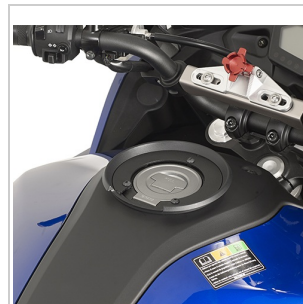

BF05



366FZ

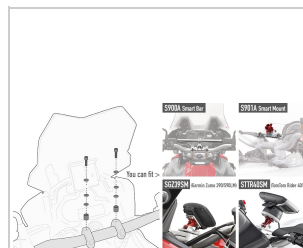

05SKIT



D448S

366FZ

Specific rear rack for MONOKEY® or MONOLOCK® top-case *to be combined with the MONOKEY® M5, M7, M8A, M8B, M9A or M9B plates, or with the MONOLOCK® M5M or M6M plates, or with the aluminium bag holder EX2M / if combined with M8A, M8B, M9A, M9B it does not allow the assembly of the stop light kit or the remote control device on the top-case / maximum load allowed 6 Kg*

BF05

Specific flange for fitting any of the TANKLOCK, Tanklocked bags

D448S

Specific screen, smoked 55,5 x 55,5 cm (H x W) *only for Fazer 8 version / to be mounted instead of the original screen / 19 cm higher than the original*

05SKIT

Specific kit to mount the S900A Smart Bar or the S901A Smart Mount *The S901A is compatible with the supports SGZ39SM (for Garmin Zumo 345LM/390LM/395LM/590LM/595LM/346LM/396LM) and STTR40SM (for Tom Tom Rider 40/400/410/42/420/450/500/550)*

YAMAHA

MT-09 (13 > 16)

Accessories

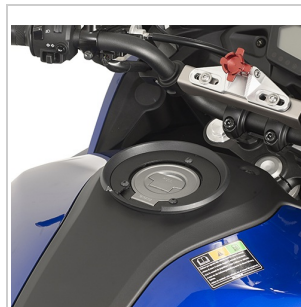

BF05



2115FZ



PR2139



A2115

2115FZ

Specific rear rack for MONOKEY® or MONOLOCK® top-case *to be combined with the MONOKEY® M5, M7, M8A, M8B, M9A or M9B plates, or with the MONOLOCK® M5M or M6M plates, or with the aluminium bag holder EX2M / if combined with M8A, M8B, M9A, M9B it does not allow the assembly of the stop light kit or the remote control device on the top-case / maximum load allowed 6 Kg*

BF05

Specific flange for fitting any of the TANKLOCK, TanklockED bags

A2115

Specific screen, smoked 28,5 x 36 cm (H x W) *complete with specific fitting kit*

PR2139

Stainless steel specific radiator guard black painted

HP2115B

Specific, technopolymer, black hand protectors

01SKIT

Specific kit to mount the S900A Smart Bar or the S901A Smart Mount *The S901A is compatible with the supports SGZ395M (for Garmin Zumo 345LM/390LM/395LM/590LM/595LM/346LM/396LM) and STTR405M (for Tom Tom Rider 40/400/410/42/420/450/500/550)*

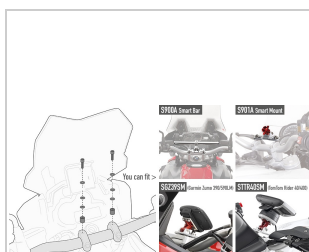

01SKIT

YAMAHA

MT-09 (17 > 20)

Accessories



TST2132

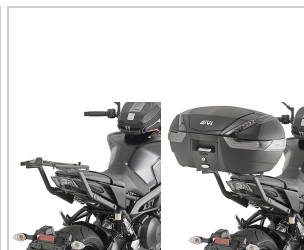

2132FZ

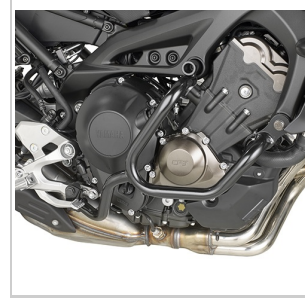

TN2132



BF05

2132FZ

Specific rear rack for MONOKEY® or MONOLOCK® top-case *to be combined with the MONOKEY® M5, M7, M8A, M8B, M9A or M9B plates, or with the MONOLOCK® M5M or M6M plates, or with the aluminium bag holder EX2M / if combined with M8A, M8B, M9A, M9B it does not allow the assembly of the stop light kit or the remote control device on the top-case / maximum load allowed 6 Kg / it is necessary to move the indicators from their original position*

TST2132

Specific holder for pair of side bags ST604 (Sport-T range) *it can be mounted without the specific rear rack 2132FZ using the IN2132KIT / it is necessary to move the indicators from their original position*

BF05

Specific flange for fitting any of the TANKLOCK, TanklockED bags

A2132

Specific screen, smoked 28 x 36,5 cm (H x W) *complete with specific fitting kit*

TN2132

Specific engine guard, black 25 mm diameter steel tube / *we recommend fitting by a qualified mechanic*

HP2115B

Specific, technopolymer, black hand protectors

01SKIT

Specific kit to mount the S900A Smart Bar or the S901A Smart Mount *The S901A is compatible with the supports SGZ395M (for Garmin Zumo 345LM/390LM/395LM/590LM/595LM/346LM/396LM) and STTR405M (for Tom Tom Rider 40/400/410/42/420/450/500/550)*

02VKIT

Specific kit to mount the Smart Mount RC S903A, S904B *needs to be mounted on the brake fluid reservoir cover right-hand side*

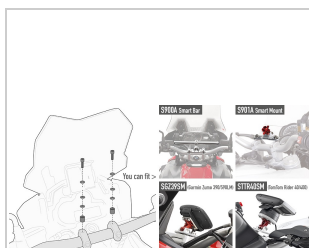

01SKIT

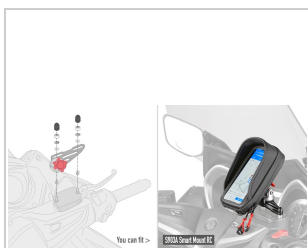

02VKIT

YAMAHA

MT-09 / MT-09 SP (21 > 22)

Accessories



TE2156



2156FZ



BF05



TR2156

2156FZ

Specific rear rack for MONOKEY® or MONOLOCK® top-case *to be combined with the MONOKEY® M5, M7, M8A, M8B, M9A or M9B plates, or with the MONOLOCK® M5M or M6M plates, or with the aluminium bag holder EX2M / if combined with M8A, M8B, M9A, M9B it does not allow the assembly of the stop light kit or the remote control device on the top-case*

TE2156

Specific holder for Easylock side bags, or soft side bags

TR2156

Specific rapid release holder REMOVE-X for soft side bags

BF05

Specific flange for fitting any of the TANKLOCK, TanklockED bags

1173S

Specific screen, smoked 22 x 31 cm (H x W) *to be combined with the specific A2156A fitting kit*

A2156A

Specific fitting kit for 1173S

PR2156

Stainless steel specific radiator guard black painted

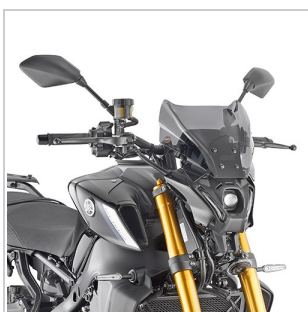

1173S

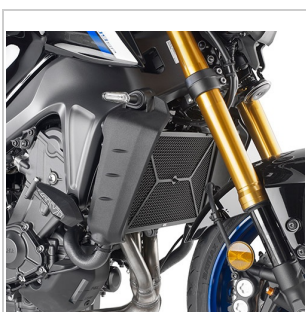

PR2156

YAMAHA

MT-09 Tracer (15 > 17)

Accessories

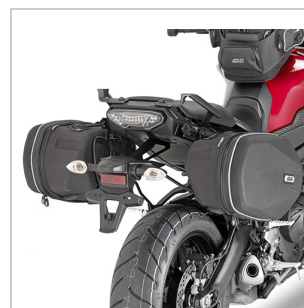

TE2122



SR2122



2122DT



BF23

SR2122

Specific rear chromed rack for MONOLOCK® or MONOKEY® top-case *to be combined with the M5, M7, M8A, M8B, M9A or M9B MONOKEY® plate, or with the M5M or M6M MONOLOCK® plate, or with the aluminium bag holder EX2M / if combined with M8A, M8B, M9A, M9B it does not allow the assembly of the stop light kit or the remote control device on the top-case*

PLR2122

Specific rapid release side-case holder for MONOKEY® or RETRO FIT cases

PLXR2122

Specific rapid release side-case holder for V35, V37 MONOKEY® SIDE cases

TE2122

Specific holder for Easylock side bags, or soft side bags

BF23

Specific flange for fitting any of the TANKLOCK, TanklockED bags

2122DT

Specific screen, transparent 69 x 50 cm (H x W) *to be combined with the specific D2122KIT fitting kit*

D2122KIT

Specific fitting kit for 2122DT

D2122S

Specific screen, smoked 48 x 42 cm (H x W) *to be mounted instead of the original screen*

TN2122

Specific engine guard, black 25 mm diameter steel tube / *we recommend fitting by a qualified mechanic*

RM2122KIT

Specific kit to install the spray guard RM01, RM02

ES2122

Specific support in aluminium and stainless steel to widen the surface support area of the original side stand

FB2122

Fairing upper bracket to be mounted behind the windshield to install S902A, S920M, S920L, S95KIT and GPS-Smartphone holder *Compatible with the original windshield and the windshield D2122S, 2122DT / For S902A, S920M, S95KIT, S920L, S952B, S953B, S954B, S955B, S956B*

04SKIT

Specific kit to mount the S900A Smart Bar or the S901A Smart Mount *The S901A is compatible with the supports SGZ395M (for Garmin Zumo 345LM/390LM/395LM/590LM/595LM/346LM/396LM) and STTR405M (for Tom Tom Rider 40/400/410/42/420/450/500/550)*

02VKIT

Specific kit to mount the Smart Mount RC S903A, S904B *needs to be mounted on the brake fluid reservoir cover right-hand side*



TN2122



RM2122KIT

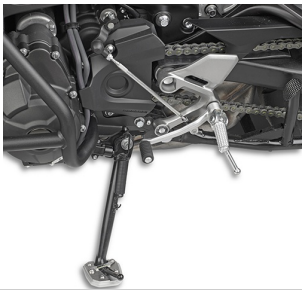

ES2122

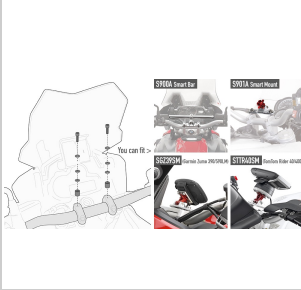

O4SKIT

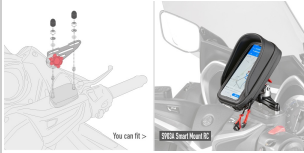

O2VKIT

YAMAHA

TDM 900 (02 > 14)

Accessories

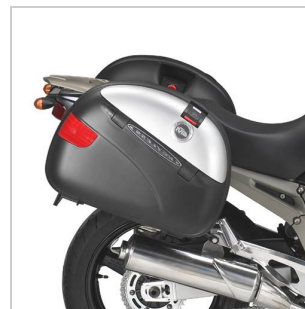

PL347



347F



BF05



PLX347

347F	Specific rear rack for MONOKEY® or MONOLOCK® top-case <i>To be combined with the plate MONOKEY® M3, or with the plate MONOLOCK® MM / maximum load allowed 6 Kg</i>
PL347	Specific pannier holder for MONOKEY® or RETRO FIT side-cases <i>maximum load allowed 3 kg / it is necessary to move the indicators from their original position</i>
PLX347	Specific pannier holder for V35 MONOKEY® SIDE cases <i>it is necessary to move the indicators from their original position / only compatible with V35 MONOKEY® SIDE</i>
BF05	Specific flange for fitting any of the TANKLOCK, Tanklocked bags
D132S	Specific screen, smoked 41 x 32,5 cm (H x W) <i>to be mounted instead of the original screen</i>
TN347	Specific engine guard 25 mm diameter steel tube / <i>we recommend fitting by a qualified mechanic</i>
05SKIT	Specific kit to mount the S900A Smart Bar or the S901A Smart Mount <i>The S901A is compatible with the supports SGZ395M (for Garmin Zumo 345LM/390LM/395LM/590LM/595LM/346LM/396LM) and STTR40SM (for Tom Tom Rider 40/400/410/42/420/450/500/550)</i>



D132S

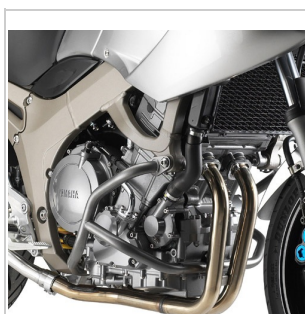

TN347

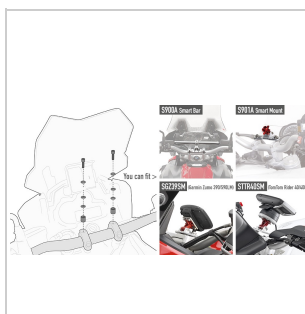

05SKIT

YAMAHA

XSR900 (16 > 21)

Accessories

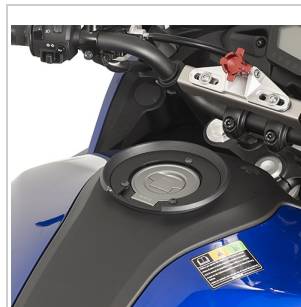

BF05



2115FZ



PR2128

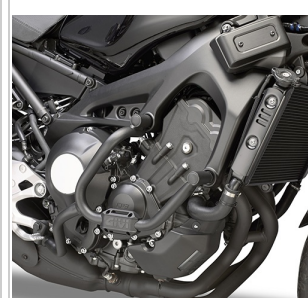

TN2128

2115FZ

Specific rear rack for MONOKEY® or MONOLOCK® top-case *to be combined with the MONOKEY® M5, M7, M8A, M8B, M9A or M9B plates, or with the MONOLOCK® M5M or M6M plates, or with the aluminium bag holder EX2M / if combined with M8A, M8B, M9A, M9B it does not allow the assembly of the stop light kit or the remote control device on the top-case / maximum load allowed 6 Kg*

BF05

Specific flange for fitting any of the TANKLOCK, TanklockED bags *only compatible with TANKLOCK, TanklockED bags of up to 5 ltr in capacity / as the BF05 flange is not positioned centrally on the fuel tank, please be aware that the mounted position of the tanklock bag will not be central on the fuel tank*

100AL

Grey anodised aluminium universal screen Race Cafe, for naked motorcycles 20,5 x 26,5 cm (H x W) *to be combined with the specific AL2128A fitting kit*

100ALB

Black anodised aluminium universal screen Race Cafe, for naked motorcycles 20,5 x 26,5 cm (H x W) *to be combined with the specific AL2128A fitting kit*

140A

Universal transparent screen 35 x 41cm (H x W) *to be combined with the specific AL2128A fitting kit*

140S

Universal smoked screen 35 x 41 cm (H x W) *to be combined with the specific AL2128A fitting kit*

TN2128

Specific engine guard, black 25 mm diameter steel tube / *we recommend fitting by a qualified mechanic*

PR2128

Stainless steel specific radiator guard black painted

ES2122

Specific support in aluminium and stainless steel to widen the surface support area of the original side stand

01SKIT

Specific kit to mount the S900A Smart Bar or the S901A Smart Mount *The S901A is compatible with the supports SGZ395M (for Garmin Zumo 345LM/390LM/395LM/590LM/595LM/346LM/396LM) and STTR405M (for Tom Tom Rider 40/400/410/42/420/450/500/550)*

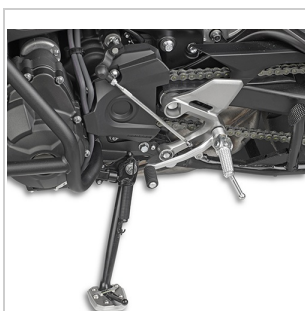

ES2122



01SKIT

YAMAHA

Niken 900 (19 > 22)

Accessories

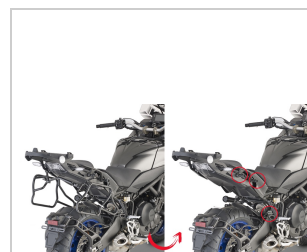

PLXR2143



SR2143



D2144ST



BF05

SR2143

Specific rear rack for MONOLOCK® or MONOKEY® top-case *to be combined with the M5, M7, M8A, M8B, M9A or M9B MONOKEY® plate, or with the M5M or M6M MONOLOCK® plate, or with the aluminium bag holder EX2M / if combined with M8A, M8B, M9A, M9B it does not allow the assembly of the stop light kit or the remote control device on the top-case*

PLXR2143

Specific rapid release side-case holder for V35, V37 MONOKEY® SIDE cases

BF05

Specific flange for fitting any of the TANKLOCK, Tanklocked bags

D2144ST

Specific screen, transparent 58 x 59 cm (H x L) *to be combined with the specific D2143KIT fitting kit / to be mounted instead of the original screen*

D2143KIT

Specific fitting kit for D2144ST

ES2122

Specific support in aluminium and stainless steel to widen the surface support area of the original side stand

01SKIT

Specific kit to mount the S900A Smart Bar or the S901A Smart Mount *The S901A is compatible with the supports SGZ395M (for Garmin Zumo 345LM/390LM/395LM/590LM/595LM/346LM/396LM) and STTR40SM (for Tom Tom Rider 40/400/410/42/420/450/500/550)*

02VKIT

Specific kit to mount the Smart Mount RC S903A, S904B *needs to be mounted on the brake fluid reservoir cover right-hand side*

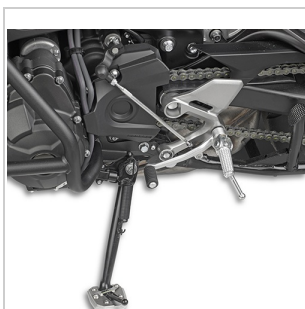

ES2122

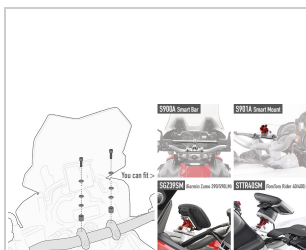

01SKIT

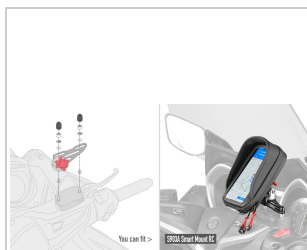

02VKIT

YAMAHA

Niken GT 900 (19 > 22)

Accessories

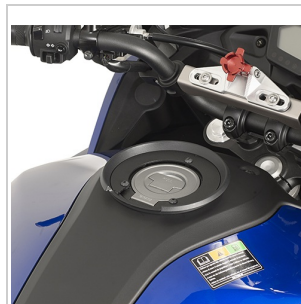

BF05



SR2144



ES2122



D2144ST

SR2144

Specific rear rack for MONOLOCK® or MONOKEY® top-case *to be combined with the M5, M7, M8A, M8B, M9A or M9B MONOKEY® plate, or with the M5M or M6M MONOLOCK® plate, or with the aluminium bag holder EX2M / if combined with M8A, M8B, M9A, M9B it does not allow the assembly of the stop light kit or the remote control device on the top-case*

BF05

Specific flange for fitting any of the TANKLOCK, TanklockED bags

D2144ST

Specific screen, transparent 58 x 59 cm (H x L) *to be mounted instead of the original screen / 16,5 cm higher than the original*

ES2122

Specific support in aluminium and stainless steel to widen the surface support area of the original side stand

01SKIT

Specific kit to mount the S900A Smart Bar or the S901A Smart Mount *The S901A is compatible with the supports SGZ395M (for Garmin Zumo 345LM/390LM/395LM/590LM/595LM/346LM/396LM) and STTR40SM (for Tom Tom Rider 40/400/410/42/420/450/500/550)*

02VKIT

Specific kit to mount the Smart Mount RC S903A, S904B *needs to be mounted on the brake fluid reservoir cover right-hand side*

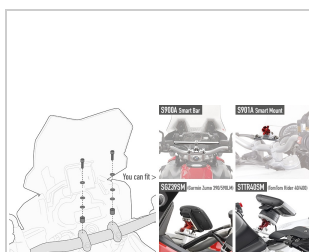

01SKIT

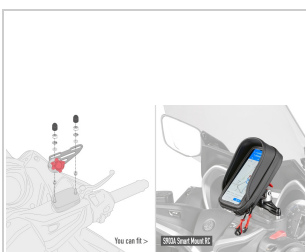

02VKIT

YAMAHA

Tracer 900 / Tracer 900 GT (18 > 20)

Accessories



BF23

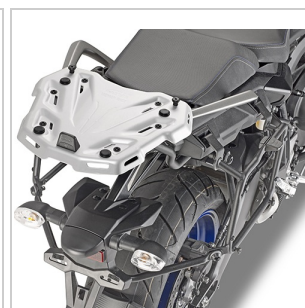

SR2139



RP2139

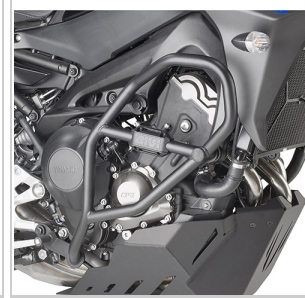

TN2139

SR2139

Specific rear rack for MONOLOCK® or MONOKEY® top-case *to be combined with the M5, M8A, M8B, M9A or M9B MONOKEY® plate, or with the M5M or M6M MONOLOCK® plate, or with the aluminium bag holder EX2M / if combined with M8A, M8B, M9A, M9B it does not allow the assembly of the stop light kit or the remote control device on the top-case*

PLR2139

Specific rapid release side-case holder for MONOKEY® or RETRO FIT cases *it can be mounted without the specific rear rack SR2139 using the 2139KIT*

PLXR2139

Specific rapid release side-case holder for V35, V37 MONOKEY® SIDE cases *it can be mounted without the specific rear rack SR2139 using the 2139KIT*

PL2139CAM

Specific pannier holder for Trekker Outback MONOKEY® CAM-SIDE 18 mm diameter / *it can be mounted without the specific rear rack SR2139 using the 2139KIT*

2139KIT

Specific kit to install the PLR2139, PLXR2139, PL2139CAM without the specific rear rack SR2139

S250KIT

Universal kit to install the S250 Tool Box *it can be mounted on either the right-hand side or left-hand side of the PL2139CAM / To be combined with S250 and the specific pannier holder*

TR2139

Specific rapid release holder REMOVE-X for soft side bags

BF23

Specific flange for fitting any of the TANKLOCK, TanklockED bags

D2139S

Specific screen, smoked 55 x 46,5 cm (H x W) *to be mounted instead of the original screen / 6 cm higher than the original*

2139DT

Specific screen, transparent 69,5 x 48 cm (H x W) *to be combined with the specific D2139KIT fitting kit / 20,5 cm higher than the original*

D2139KIT

Specific fitting kit for 2139DT

TN2139

Specific engine guard, black 25 mm diameter steel tube / *we recommend fitting by a qualified mechanic*

RP2139

Oil carter protector in black brushed and anodised aluminium

PR2139

Stainless steel specific radiator guard black painted

RM2139KIT

Specific kit to install the spray guard RM02

SLD2139KIT

Specific kit to install the frame slider SLD01__ *to be combined with slider SLD01__*

ES2122

Specific support in aluminium and stainless steel to widen the surface support area of the original side stand

LS2139

Specific fitting kit to mount spotlights where specific engine guard is not present

EH2139

Extension in smoked plexiglass for original hand protectors

04SKIT	Specific kit to mount the S900A Smart Bar or the S901A Smart Mount <i>The S901A is compatible with the supports SGZ39SM (for Garmin Zumo 345LM/390LM/395LM/590LM/595LM/346LM/396LM) and STTR40SM (for Tom Tom Rider 40/400/410/42/420/450/500/550)</i>
---------------	--

02VKIT	Specific kit to mount the Smart Mount RC S903A, S904B <i>needs to be mounted on the brake fluid reservoir cover right-hand side</i>
---------------	---

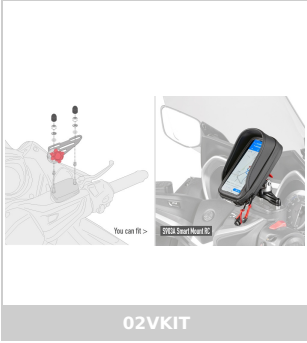
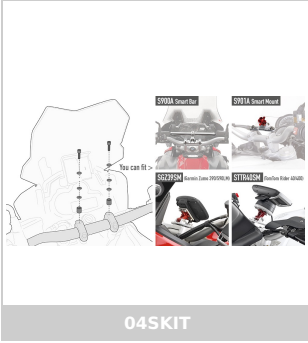

YAMAHA

Tracer 9 / Tracer 9 GT (21-22)

Accessories

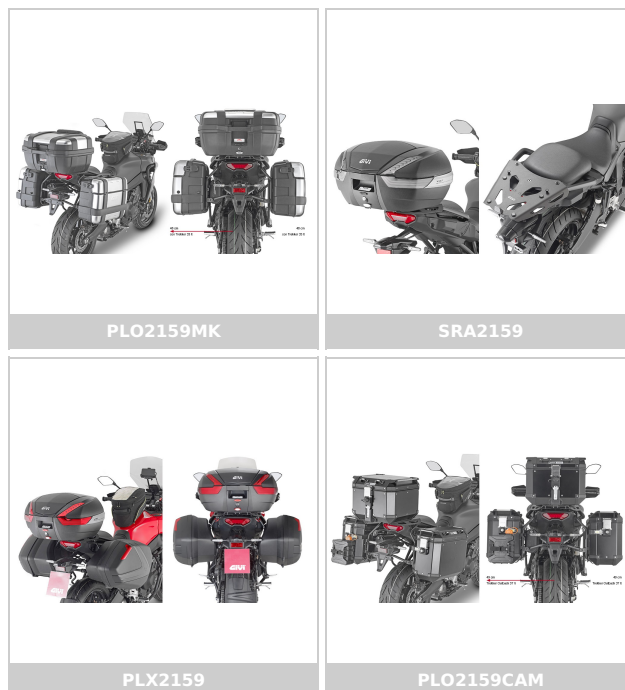

SRA2159

Specific rear rack, black, in anodised aluminium for MONOKEY® top-case *maximum load allowed 5kg / it does not allow the assembly of the stop light kit or the remote control device on the top-case*

PLO2159MK

Specific pannier holder PL ONE-FIT for MONOKEY® side-cases configuration *18 mm diameter / to be combined with 07RKIT for the transformation into Rapid Release pannier holder*

PLO2159CAM

Specific pannier holder PL ONE-FIT for Trekker Outback MONOKEY® CAM-SIDE configuration *18 mm diameter / to be combined with 07RKIT for the transformation into Rapid Release pannier holder*

PLX2159

Specific pannier holder for V35, V37 MONOKEY® SIDE cases *to be combined with 07RKIT for the transformation into Rapid Release pannier holder*

07RKIT

RAPID RELEASE kit that allows you to transform the side case holder into a quick-release frame

TL8400KIT

Specific kit to install the S250 Tool Box on S250 Tool Box on PLO2159MK or PLO2159CAM *to be combined with S250 and PLO2159MK, PLO2159CAM / needs to be mounted on the left-hand side of the motorcycle*

TR2159

Specific rapid release holder REMOVE-X for soft side bags

BF23

Specific flange for fitting any of the TANKLOCK, TanklockED bags

D2159ST

Specific screen, transparent, 64 x 45 cm (H x W) *to be mounted instead of the original screen*

D2159S

Specific screen, smoked, 49 x 39 cm (H x W) *to be mounted instead of the original screen*

TN2159B

Specific engine guard, black *25 mm diameter steel tube / we recommend fitting by a qualified mechanic*

PR2156

Stainless steel specific radiator guard black painted

RM2159KIT

Specific kit to install the spray guard RM02

ES2159

Specific support in aluminium and stainless steel to widen the surface support area of the original side stand

FB2159

Fairing upper bracket to be mounted behind the windshield to install S902A, S920M, S920L, S95KIT and GPS-Smartphone holder *For S902A, S920M, S920L, S952B, S953B, S954B, S955B, S956B, S957B, S958B, S95KIT*

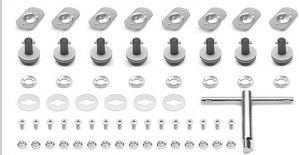

07RKIT



TL8400KIT



BF23



D2159ST



D2159S



PR2156



RM2159KIT



ES2159



FB2159

YAMAHA

FZS 1000 Fazer (01 > 02)**Accessories****D129S****348FZ****348FZ**

Specific rear rack for MONOKEY® or MONOLOCK® top-case *to be combined with the MONOKEY® M5, M7, M8A, M8B, M9A or M9B plates, or with the MONOLOCK® M5M or M6M plates, or with the aluminium bag holder EX2M / if combined with M8A, M8B, M9A, M9B it does not allow the assembly of the stop light kit or the remote control device on the top-case*

D129S

Specific screen, smoked 43 x 33 cm (H x W) *to be mounted instead of the original screen*

YAMAHA

FZS 1000 Fazer (03 > 05)**Accessories****D129S****348FZ****348FZ**

Specific rear rack for MONOKEY® or MONOLOCK® top-case *to be combined with the MONOKEY® M5, M7, M8A, M8B, M9A or M9B plates, or with the MONOLOCK® M5M or M6M plates, or with the aluminium bag holder EX2M / if combined with M8A, M8B, M9A, M9B it does not allow the assembly of the stop light kit or the remote control device on the top-case*

D129S

Specific screen, smoked 43 x 33 cm (H x W) *to be mounted instead of the original screen*

YAMAHA

FZ1 Fazer 1000 (06 > 15)**Accessories**

PLX359



359FZ



D437S

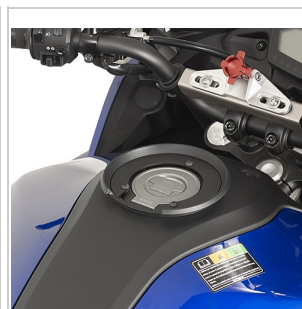

BF05

359FZ

Specific rear rack for MONOLOCK® top-case *to be combined with the MONOLOCK® M5M or M6M plates / it requires fitment of top-case up to 37 ltr / maximum load allowed 6 kg / it is necessary to puncture the housing under the tail in arranged sections*

PLX359

Specific pannier holder for V35 *it can be mounted without the specific rear rack 359FZ using the PLX359KIT / it is necessary to move the indicators from their original position*

BF05

Specific flange for fitting any of the TANKLOCK, TanklockED bags

D437S

Specific screen, smoked 52 x 44 cm (H x W) *to be mounted instead of the original screen / 14 cm higher than the original*

YAMAHA

FZ1 1000 (06 > 15)

Accessories



PLX359



365FZ

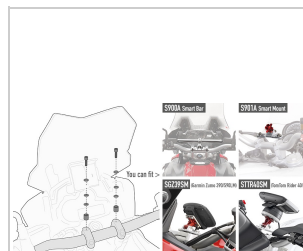

05SKIT

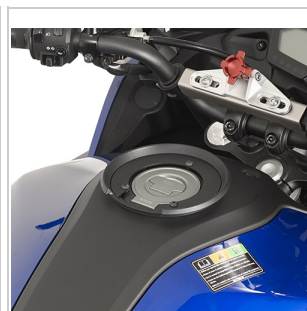

BF05

365FZ

Specific rear rack for MONOLOCK® top-case *we recommend mounting smaller cases MONOLOCK® in conjunction with M5M or M6M plate / It requires fitment of cases up to 35 ltr / maximum load allowed 6 kg / it is necessary to puncture the housing under the tail in arranged sections*

PLX359

Specific pannier holder for V35 *it is necessary to move the indicators from their original position / it can be mounted without the specific rear rack 359FZ using the 365KIT*

BF05

Specific flange for fitting any of the TANKLOCK, TanklockED bags

05SKIT

Specific kit to mount the S900A Smart Bar or the S901A Smart Mount *The S901A is compatible with the supports SGZ39SM (for Garmin Zumo 345LM/390LM/395LM/590LM/595LM/346LM/396LM) and STTR40SM (for Tom Tom Rider 40/400/410/42/420/450/500/550)*

YAMAHA

MT-10 (16 > 21)

Accessories

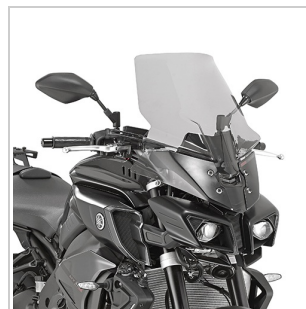

D2129S



BF27

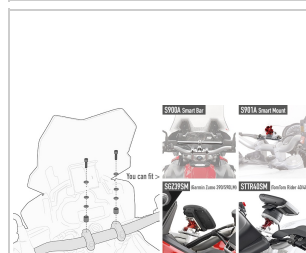

01SKIT



D2129B

SR2129

Specific rear rack for MONOLOCK® or MONOKEY® top-case *to be combined with the M5, M7, M8A, M8B, M9A or M9B MONOKEY® plate, or with the M5M or M6M MONOLOCK® plate, or with the aluminium bag holder EX2M / if combined with M8A, M8B, M9A, M9B it does not allow the assembly of the stop light kit or the remote control device on the top-case / maximum load allowed 6 kg*

PLXR2129

Specific rapid release side-case holder for V35, V37 MONOKEY® SIDE cases

BF27

Specific flange for fitting any of the TANKLOCK, TanklockED bags

D2129S

Specific screen, smoked 53,5 x 42 cm (H x W) *to be mounted instead of the original screen*

D2129B

Specific low sports screen gloss black 36 x 36 cm (H x W) *to be mounted instead of the original screen*

01SKIT

Specific kit to mount the S900A Smart Bar or the S901A Smart Mount *The S901A is compatible with the supports SGZ395M (for Garmin Zumo 345LM/390LM/395LM/590LM/595LM/346LM/396LM) and STTR405M (for Tom Tom Rider 40/400/410/42/420/450/500/550)*

YAMAHA

BT 1100 Bulldog (02 > 09)**Accessories****350FZ**

Specific rear rack for MONOKEY® or MONOLOCK® top-case *to be combined with the MONOKEY® M5, M7, M8A, M8B, M9A or M9B plates, or with the MONOLOCK® M5M or M6M plates, or with the aluminium bag holder EX2M / if combined with M8A, M8B, M9A, M9B it does not allow the assembly of the stop light kit or the remote control device on the top-case*

YAMAHA

XT 1200Z Super TÄ©nÄ©rÄ© (10 > 20)

Accessories



SRA2101



SR371



D447ST

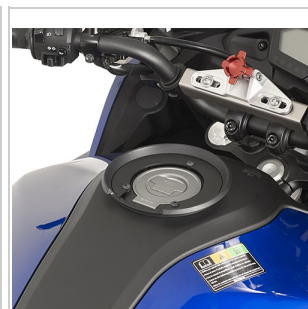

BF05

SR371

Specific rear rack for MONOKEY® top-case *MONOKEY® plate included / compatible with the original side-case holder / to open the original side-cases you should remove the top-case from the plate*

SRA2101

Specific rear rack in anodised aluminium for MONOKEY® top-case *It can only be mounted on the original rack / It can only be mounted on the original rack / it can be fitted with the original side-case holders / to open the original side-cases you should remove the top-case from the plate / maximum load allowed 6kg / it does not allow the assembly of the stop light kit or the remote control device on the case*

PL2119CAM

Specific pannier holder for Trekker Outback MONOKEY® CAM-SIDE *18 mm diameter*

PLR2119

Specific rapid release side-case holder for MONOKEY® or RETRO FIT cases

PL2119

Specific pannier holder for MONOKEY® or RETRO FIT side-cases

BF05

Specific flange for fitting any of the TANKLOCK, TanklockED bags

D447ST

Specific screen, transparent 57 x 44 cm (H x W) *to be mounted instead of the original screen / 13 cm higher than the original / not compatible on version with a height adjustable windshield*

D2119ST

Specific screen, transparent 56,5 x 50 cm (H x W) *only compatible with version with a height adjustable windshield / to be mounted instead of the original screen / 11 cm higher than the original*

TN355

Specific engine guard 25 mm diameter steel tube / *we recommend fitting by a qualified mechanic*

TL2119KIT

Specific kit to install the S250 Tool Box beneath the TN355 engine guard *to be combined with S250 and TN355 / it can be mounted on either the right-hand side or left-hand side of the motorcycle*

RP2119

Oil carter protector in brushed and anodised aluminium



TN355

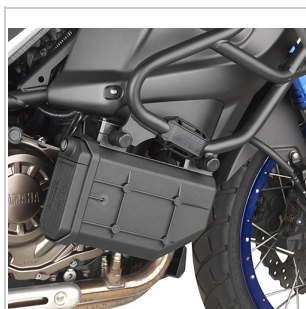

TL2119KIT



RP2119

YAMAHA

XT1200ZE Super TÄ©nÄ©rÄ© (14 > 20)

Accessories



SR371



SRA2101



RP2119



BF05

SRA2101

Specific rear rack in anodised aluminium for MONOKEY® top-case *can only be mounted to the original rack / It can only be mounted on the original rack / it can be fitted with the original side-case holders / to open the original side-cases you should remove the top-case from the plate / maximum load allowed 6kg / it does not allow the assembly of the stop light kit or the remote control device on the case*

SR371

Specific rear rack for MONOKEY® top-case *it is necessary to remove the original rack / MONOKEY® plate included / compatible with the original side-case holder / to open the original side-cases you should remove the top-case from the plate*

PL2119

Specific pannier holder for MONOKEY® or RETRO FIT side-cases

PLR2119

Specific rapid release side-case holder for MONOKEY® or RETRO FIT cases

PL2119CAM

Specific pannier holder for Trekker Outback MONOKEY® CAM-SIDE 18 mm diameter

BF05

Specific flange for fitting any of the TANKLOCK, Tanklocked bags

D2119ST

Specific screen, transparent 56,5 x 50 cm (H x W) *to be mounted instead of the original screen / 11 cm higher than the original*

RP2119

Oil carter protector in brushed and anodised aluminium

TN355

Specific engine guard 25 mm diameter steel tube / *we recommend fitting by a qualified mechanic*

TL2119KIT

Specific kit to install the S250 Tool Box beneath the TN355 engine guard *to be combined with S250 and TN355 / it can be mounted on either the right-hand side or left-hand side of the motorcycle*

ES2119

Specific support in aluminium and stainless steel to widen the surface support area of the original side stand

01SKIT

Specific kit to mount the S900A Smart Bar or the S901A Smart Mount *The S901A is compatible with the supports SGZ395M (for Garmin Zumo 345LM/390LM/395LM/590LM/595LM/346LM/396LM) and STTR40SM (for Tom Tom Rider 40/400/410/42/420/450/500/550)*



TN355

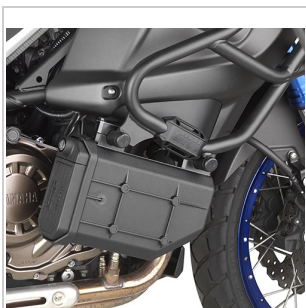

TL2119KIT

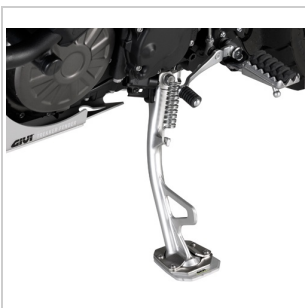

ES2119

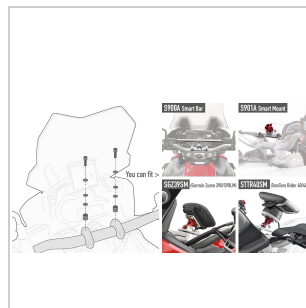

01SKIT

YAMAHA

FJR 1300 (01 > 05)

Accessories



D134ST



SR346

SR346

Specific rear rack for MONOKEY® top-case *MONOKEY® plate included / compatible with the original side-case holder / maximum load allowed 6 Kg*

D134ST

Specific screen, transparent 47 x 51 cm (H x W) *to be mounted instead of the original screen / 5 cm higher than the original*

YAMAHA

FJR 1300 (06 > 12)

Accessories

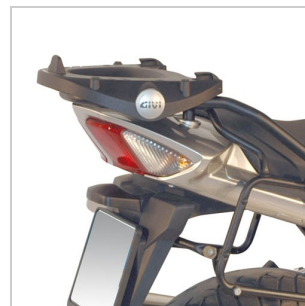

SR357

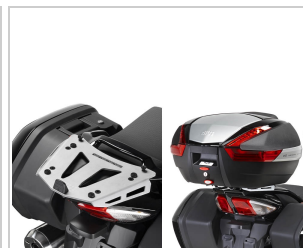

SRA2109



D436ST

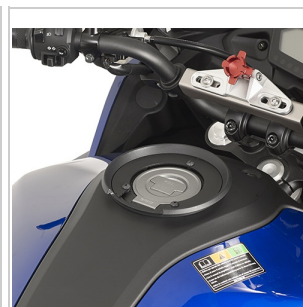

BF05

E228	Specific rear rack for MONOKEY® top-case <i>MONOKEY® plate included / maximum load 6 Kg.</i>
E228M	Specific rear rack for MONOLOCK® top-case <i>MONOLOCK® plate included / maximum load 6 Kg.</i>
SRA2109	Specific rear rack in anodised aluminium for MONOKEY® top-case <i>maximum load allowed 6kg / it does not allow the assembly of the stop light kit or the remote control device on the top-case</i>
SR357	Specific rear rack for MONOKEY® top-case <i>MONOKEY® plate included</i>
BF05	Specific flange for fitting any of the TANKLOCK, TanklockED bags
D436ST	Specific screen, transparent 52 x 49,5 cm (H x W) <i>to be mounted instead of the original screen / 5 cm higher than the original</i>

YAMAHA

FJR 1300 (13 > 20)



Accessories



SR357

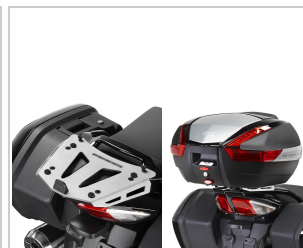

SRA2109



D2109ST

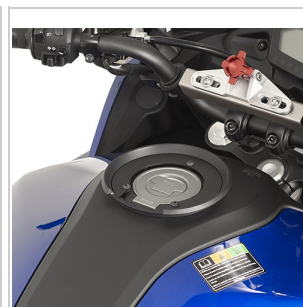

BF05

E228 Specific rear rack for MONOKEY® top-case *MONOKEY® plate included / maximum load 6 Kg.*

E228M Specific rear rack for MONOLOCK® top-case *MONOLOCK® plate included / maximum load 6 Kg.*

SRA2109 Specific rear rack in anodised aluminium for MONOKEY® top-case *maximum load allowed 6kg / it does not allow the assembly of the stop light kit or the remote control device on the top-case*

SR357 Specific rear rack for MONOKEY® top-case *MONOKEY® plate included*

BF05 Specific flange for fitting any of the TANKLOCK, TanklockED bags

D2109ST Specific screen, transparent 55,3 x 53 cm (H x W) *to be mounted instead of the original screen*

YAMAHA

XJR 1300 (98 > 02)**Accessories****341F**

Specific rear rack for MONOKEY® or MONOLOCK® top-case *To be combined with the plate MONOKEY® M3, or with the plate MONOLOCK® MM*

YAMAHA

XJR 1300 (07 > 14)

Accessories

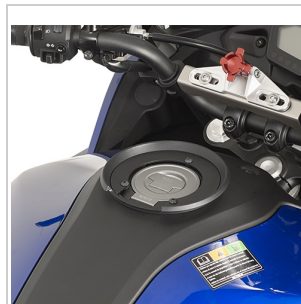

BF05



361F

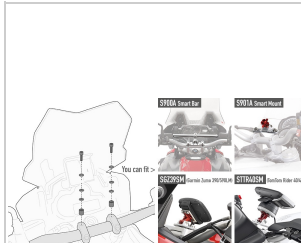

05SKIT

361F	Specific rear rack for MONOKEY® or MONOLOCK® top-case <i>To be combined with the plate MONOKEY® M3, or with the plate MONOLOCK® MM</i>
BF05	Specific flange for fitting any of the TANKLOCK, TanklockED bags
05SKIT	Specific kit to mount the S900A Smart Bar or the S901A Smart Mount <i>The S901A is compatible with the supports SGZ39SM (for Garmin Zumo 345LM/390LM/395LM/590LM/595LM/346LM/396LM) and STTR40SM (for Tom Tom Rider 40/400/410/42/420/450/500/550)</i>

YAMAHA

D'elight 114 (13 > 16)

2114A

Specific screen, transparent 40 x 72 cm (H x W) *only available if article A2114A is already fitted* (0-0)

YAMAHA

WR250R (08 > 13)

05SKIT

Specific kit to mount the S900A Smart Bar or the S901A Smart Mount *The S901A is compatible with the supports SGZ395M (for Garmin Zumo 345LM/390LM/395LM/590LM/595LM/346LM/396LM) and STTR405M (for Tom Tom Rider 40/400/410/42/420/450/500/550)* (0-0)

YAMAHA

FZS 600 Fazer (98 > 03)

340F

Specific rear rack for MONOKEY® or MONOLOCK® top-case *To be combined with the plate MONOKEY® M3, or with the plate MONOLOCK® MM* (0-0)

YAMAHA

XJ 600 Diversion (91 > 95)

325F

Specific rear rack for MONOKEY® or MONOLOCK® top-case *To be combined with the plate MONOKEY® M3, or with the plate MONOLOCK® MM* (0-0)

YAMAHA

XJ 600 Diversion (96 > 03)

325F

Specific rear rack for MONOKEY® or MONOLOCK® top-case *To be combined with the plate MONOKEY® M3, or with the plate MONOLOCK® MM* (0-0)

D116S

Specific screen, smoked 46 x 33,5 cm (H x W) *to be mounted instead of the original screen* (0-0)

YAMAHA

XJ 600 Diversion N (96 > 99)

325F

Specific rear rack for MONOKEY® or MONOLOCK® top-case *To be combined with the plate MONOKEY® M3, or with the plate MONOLOCK® MM* (0-0)

YAMAHA

XVS 650 Drag Star (97 > 02)

A35N

Universal screen, 54,9 x 46,8 cm (H x W) *to be combined with the specific AS100A2 fitting kit / high and shaded bottom version* (0-0)

A23

Universal screen, 38,8 x 41 cm (H x W) *to be combined with the specific AS100A2 fitting kit / low, transparent version* (0-0)

YAMAHA

XT 660 R / XT 660 X (07 > 16)

D433S

Specific screen, smoked 37 x 36,5 cm (H x W) *only for XT 660 R version / to be mounted instead of the original screen* (0-0)

YAMAHA

XTZ 750 Super TÃ©nÃ©rÃ© (89 > 99)

D98S

Specific screen, smoked 35,4 x 28,6 cm (H x W) *compatible from '91 to '94 / to be mounted instead of the original screen (0-0)*

YAMAHA

XV 750 Virago (89 > 98)

A35N

Universal screen, 54,9 x 46,8 cm (H x W) *to be combined with the specific AS100A2 fitting kit / high and shaded bottom version (0-0)*

A23

Universal screen, 38,8 x 41 cm (H x W) *to be combined with the specific AS100A2 fitting kit / low, transparent version (0-0)*

YAMAHA

TDM 850 (96 > 01)

336F

Specific rear rack for MONOKEY® or MONOLOCK® top-case *To be combined with the plate MONOKEY® M3, or with the plate MONOLOCK® MM (0-0)*

D116S

Specific screen, smoked 46 x 33,5 cm (H x W) *to be mounted instead of the original screen (0-0)*

YAMAHA

YZF R1 1000 (09 > 12)

BF05

Specific flange for fitting any of the TANKLOCK, TanklockED bags (0-0)

YAMAHA

MT-10 (22 > 23)

SR2163

Specific rear rack for MONOLOCK® or MONOKEY® top-case *to be combined with the M5, M7 MONOKEY® plate, or with the M5M or M6M MONOLOCK® plate, or with the aluminium bag holder EX2M (0-0)*

YAMAHA

XV 1100 Virago (89 > 99)

A23

Universal screen, transparent 38,8 x 41 cm (H x W) *only available if article AS99A2 is already fitted / low, transparent version (0-0)*

A35N

Universal screen, transparent 54,9 x 46,8 cm (H x W) *only available if article AS99A2 is already fitted / high and shaded bottom version (0-0)*

YAMAHA

XVS 1100 Drag Star (99 > 02)

A23

Universal screen, 38,8 x 41 cm (H x W) *to be combined with the specific AS100A2 fitting kit / low, transparent version (0-0)*

A35N

Universal screen, 54,9 x 46,8 cm (H x W) *to be combined with the specific AS100A2 fitting kit / high and shaded bottom version (0-0)*

YAMAHA

XJR 1200 (95 > 98)

Specific rear rack for MONOKEY® or MONOLOCK® top-case *To be combined with the plate MONOKEY® M3, or with the plate MONOLOCK®*

YAMAHA

V-MAX 1200

A123 Specific screen, smoked 31 x 29,5 cm (H x W) (0-0)



GIVI®

HEADQUARTERS:

GIVI S.P.A. _ Flero (BS) Italy
Fax +39 030 35 80 518
info@givi.it _ www.givi.it

BRASIL:

GIVI DO BRASIL LTDA
Ph. +55 12 3644 8025 _ Fax +55 12 3644 8029
info@givi.com.br _ www.givi.com.br

FRANCE:

GIVI FRANCE
Ph. (04) 72 25 79 41 _ Fax (04) 72 25 03 73
givi.france@givi.fr _ www.givi.fr

GERMANY:

GIVI DEUTSCHLAND GmbH
Ph. (0) 911 955100 _ Fax (0) 911 9551022
office@givi-deutschland.de _ www.givi.de

MALAYSIA:

GIVI ASIA SDN BHD
Ph. (603) 6028 3800 _ Fax (603) 6028 1300
enquiry@givi.com.my _ www.givi.com.my

SPAIN:

GIVI CONCESSIONAIRES IBERICA S.L.U.
Ph. (93) 8906820 _ Fax (93) 8906802
givi@givi.es _ www.givi.es

UK:

GIVI UK LTD
Ph. (01327) 706220 _ Fax (01327) 706239
info@givi.co.uk _ www.givi.co.uk

USA:

GIVI USA INC
East Coast _ Ph. (704) 679 4123
West Coast _ Ph. (775) 359 0900
info@giviusa.com _ www.giviusa.com

VIETNAM:

GIVI VIETNAM CO. LTD.
Ph. +84 72 3769137 _ Fax +84 72 3769120
info@givi.com.vn _ www.givi.com.vn

INDONESIA:

PT GIVI INDONESIA
Ph. +6221 7588 2582 _ Fax +6221 7588 2431
info@givi.co.id _ www.givi.co.id

CHINA:

DONGGUAN GIVI TRADING CO. LTD.
Ph. + 86 769 22992660 _ Fax +86 769 22992680
service@givcn.com _ www.givcn.com



Find more than 1000 accessories at givimoto.com
Discover giviexplorer.com the web portal for motorcyclist



* X 1 5 5 - 2 2 *